

Joseph Lstiburek, Ph.D., P.Eng, ASHRAE Fellow

Building Science

Adventures In Building Science

www.buildingscience.com

"It isn't what we don't know that gives us trouble, it's what we know that ain't so"

Will Rogers

"There are known knowns. These are things we know. There are known unknowns. There are things that we know we don't know. But there are also unknown unknowns. There are things we don't know we don't know."

Donald Rumsfeld

Building Science Corporation Joseph Lstiburek 2

Order of Magnitude

- 1 to 10
- 10 to 100
- 100 to 1000
- 1000 to 10000
- First Order Effects, Second Order Effects....

Building Science Corporation Joseph Lstiburek 3

First Law - Conservation of Energy

Second Law - Entropy

Third Law - Absolute Zero

Building Science Corporation Joseph Lstiburek 4

In an isolated system, a process can occur only if it increases the total entropy of the system

Rudolf Clausius

Building Science Corporation Joseph Lstiburek 5

Moisture Flow Is From Warm To Cold
Moisture Flow Is From More To Less

Thermal diffusion
Molecular diffusion

Building Science Corporation Joseph Lstiburek 6

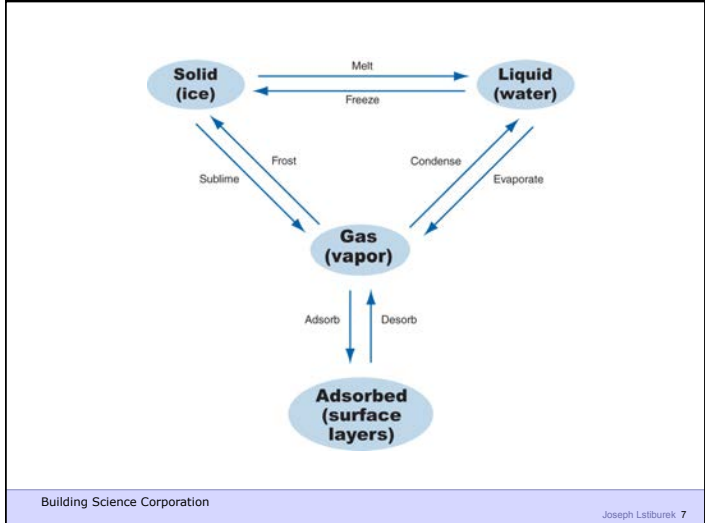

Moisture transport processes in building materials and components

Transport Process	Phase	Potential (Difference)
Gas diffusion	Vapor	Vapor pressure
Liquid diffusion	Liquid	Concentration
Surface diffusion	Adsorbate	Concentration
Thermal diffusion	Vapor and liquid	Temperature
Capillary flow	Liquid	Suction pressure
Convective flow	Vapor	Air pressure
Gravitational flow	Liquid	Height
Poiseuille flow	Liquid	Liquid pressure

From Kumaran, M. K.; Chapter 1, Moisture in Buildings, ASTM: 1994

Building Science Corporation Joseph Lstiburek 8

Water

- Vapor is a single molecule
- Liquid is molecular clumps, 75 or more

Vapor **Liquid**

Building Science Corporation

DIFFUSION

Higher Dewpoint Temperature
Higher Water Vapor Density or Concentration
(Higher Vapor Pressure)
on Warm Side of Assembly

Low Dewpoint Temperature
Lower Water Vapor Density or Concentration
(Lower Vapor Pressure)
on Cold Side of Assembly

AIR TRANSPORT

Higher Air Pressure Lower Air Pressure

Building Science Corporation Joseph Lstiburek 10

Exterior at 74°F dewpoint
Interior at 75°F and 50% RH
4x8 sheet of gypsum board
1 1/2 pints of water

Exterior at 74°F dewpoint
Interior at 75°F and 50% RH
4x8 sheet of gypsum board with a 1/2" hole
14 pints of water

Building Science Corporation Joseph Lstiburek 11

The Water Molecule

- Asymmetrical = polar
- Small: one billion = one foot

9.58 x 10⁻¹¹ μm

104.5°

0.28 nm \approx 3 Å

Building Science Corporation

The Polar Molecule

- Hydrogen end is “more” positive
- Oxygen end is “more” negative

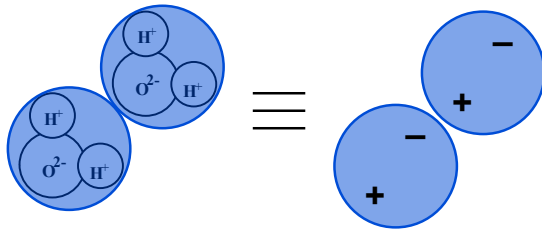

Building Science Corporation

Surface Tension: Wettable

Water attracted to surface more than self

$$\theta < 90^\circ$$

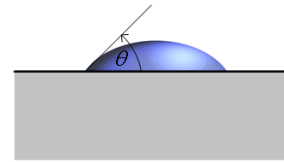

normal material:
“wetable”

Water attracted to self more than surface

$$\theta > 90^\circ$$

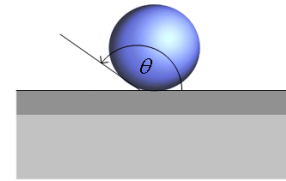

hydrophobically treated:
“non-wetable”

Building Science Corporation

Calculating capillary rise

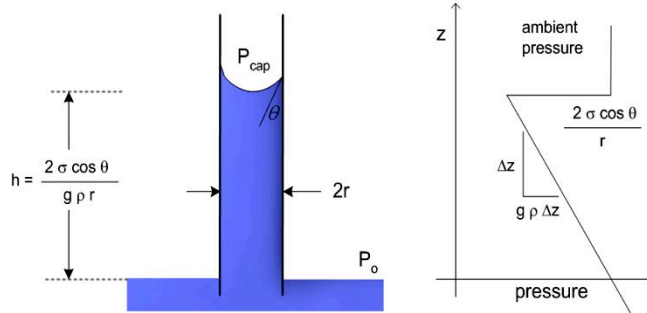

Building Science Corporation

Capillary rise versus diameter

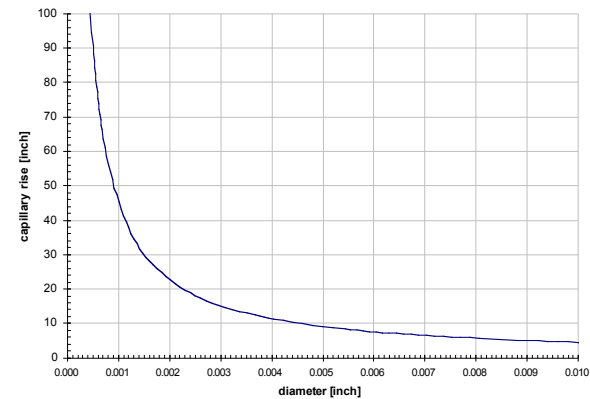

Building Science Corporation

2nd Law of Thermodynamics

Building Science Corporation Joseph Lstiburek 17

Heat Flow Is From Warm To Cold
 Moisture Flow Is From Warm To Cold
 Moisture Flow Is From More To Less
 Air Flow Is From A Higher Pressure to a Lower Pressure
 Gravity Acts Down

Building Science Corporation Joseph Lstiburek 18

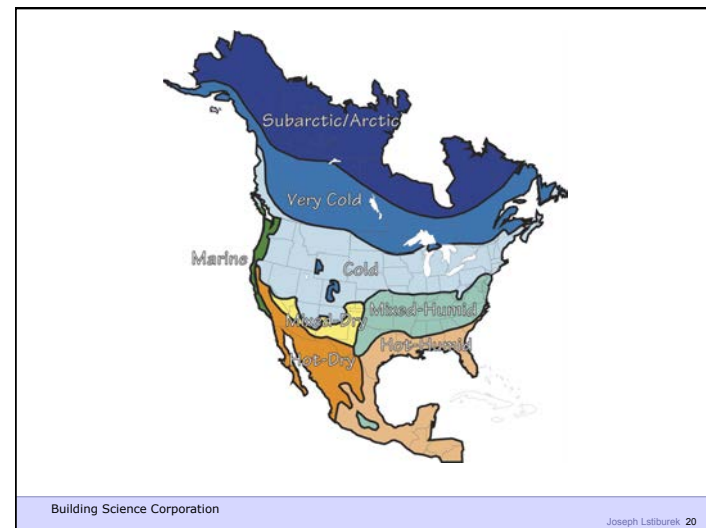
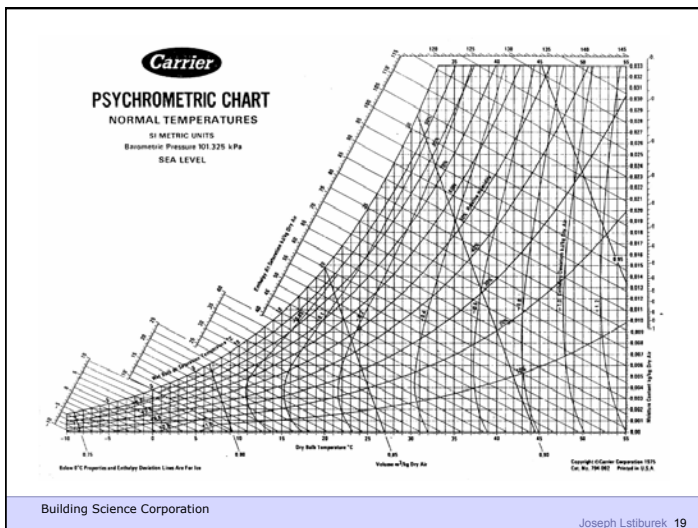

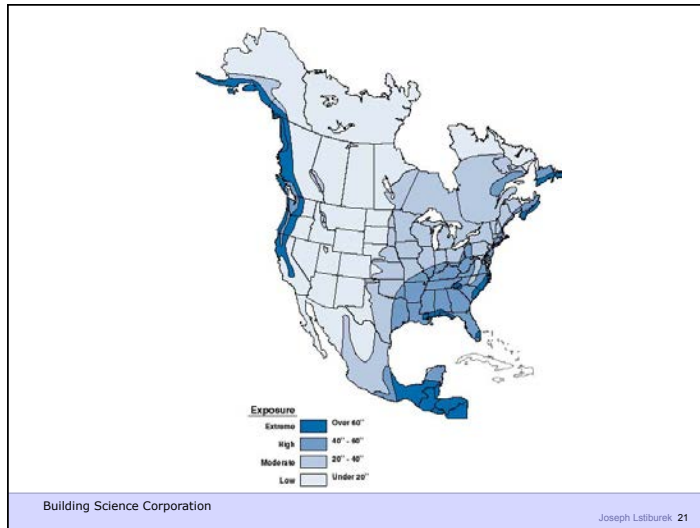

Don't Do Stupid Things

Building Science Corporation Joseph Lstiburek 22

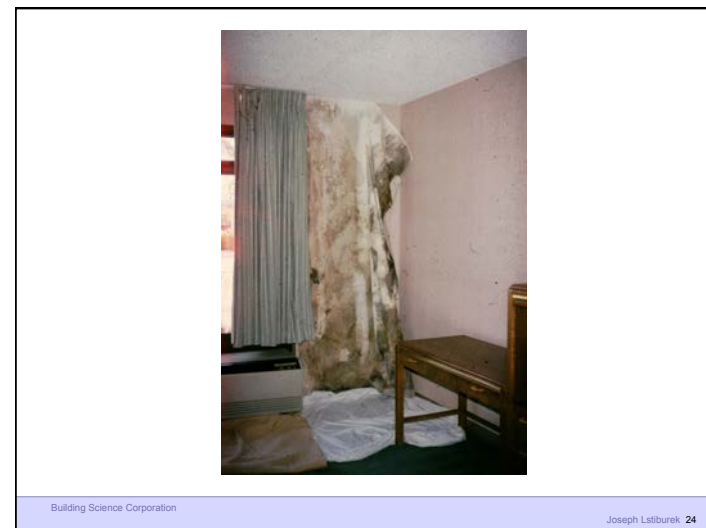



Building Science Corporation

Joseph Lstiburek 25



Building Science Corporation

Joseph Lstiburek 26

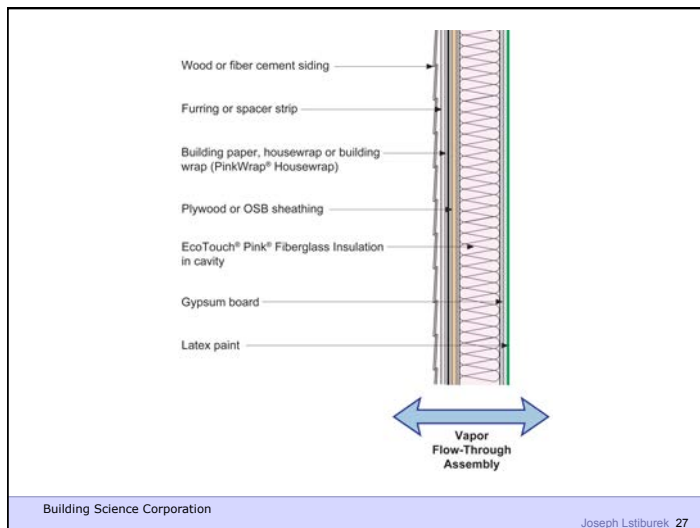

Building Science Corporation

Joseph Lstiburek 27

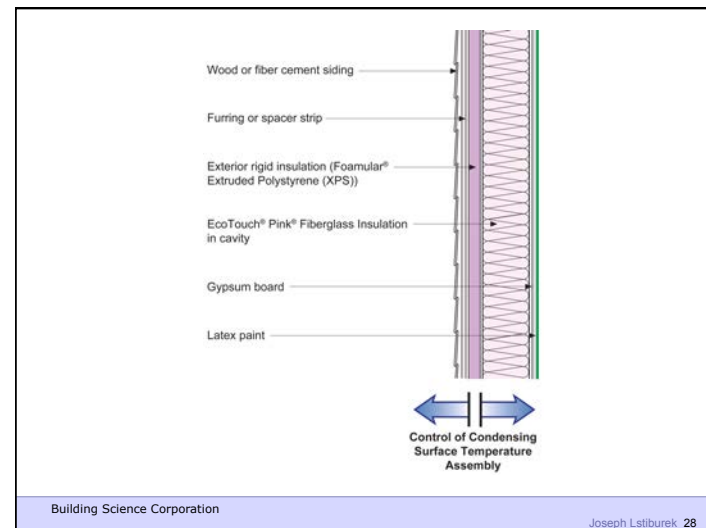

Building Science Corporation

Joseph Lstiburek 28

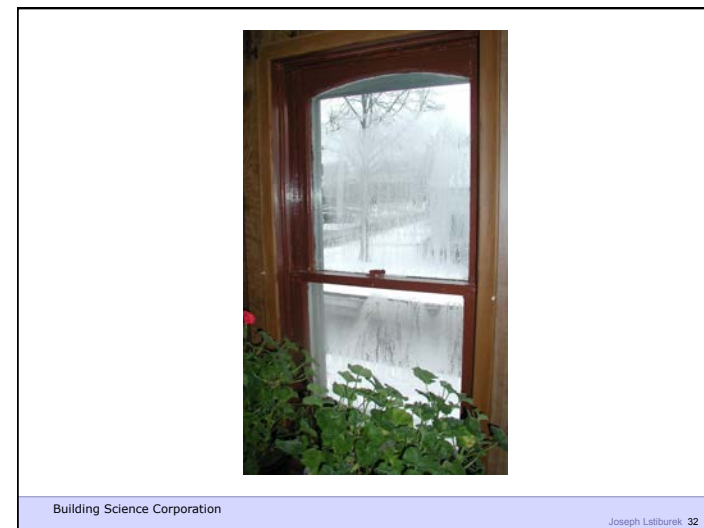
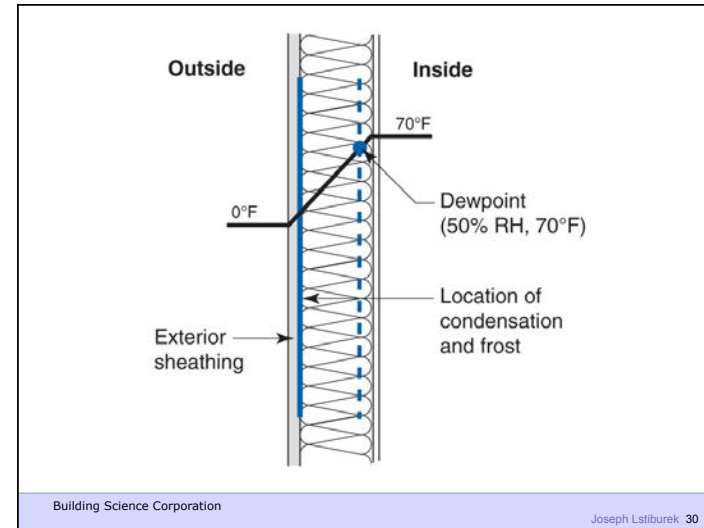
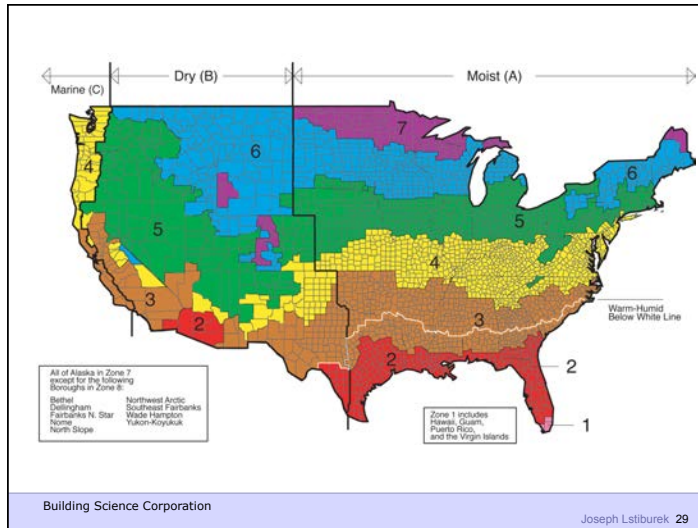

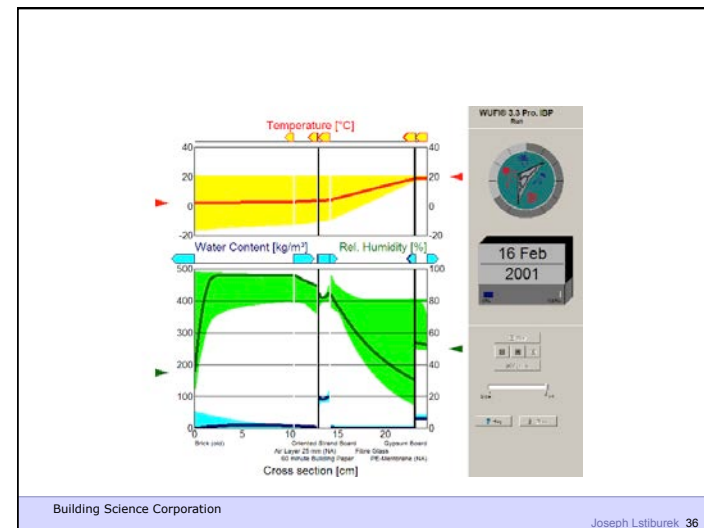
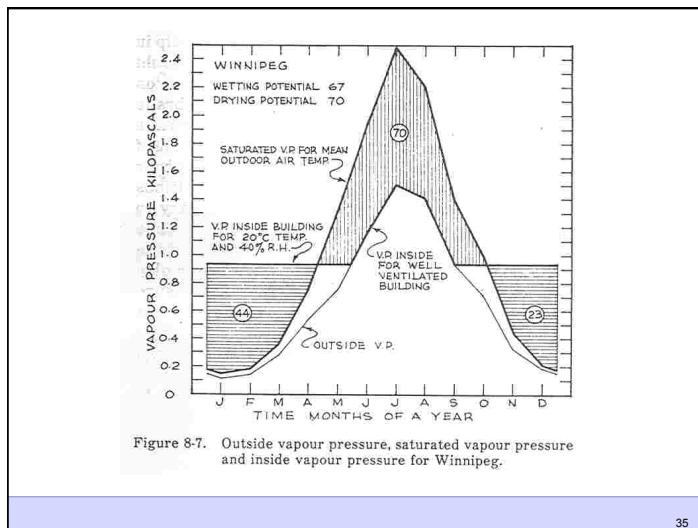
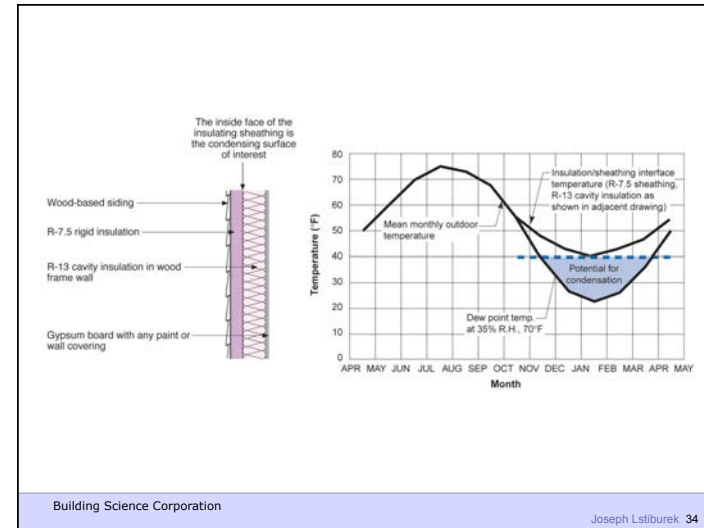
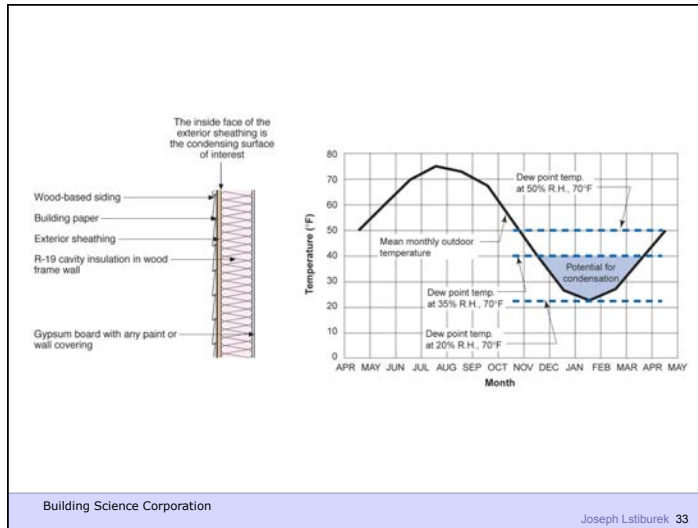

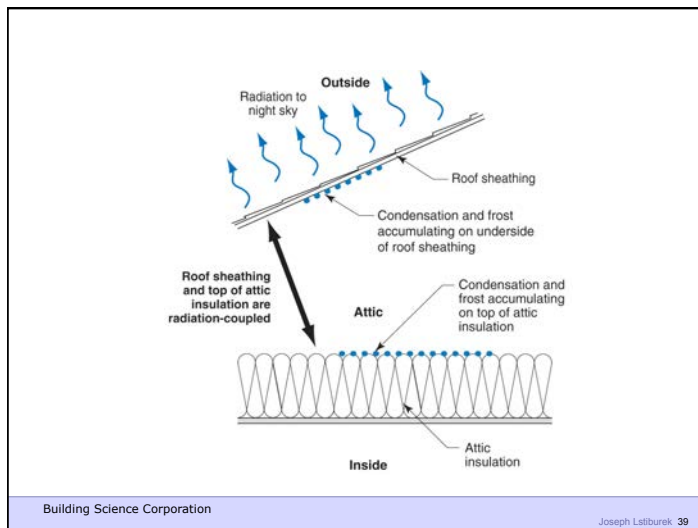
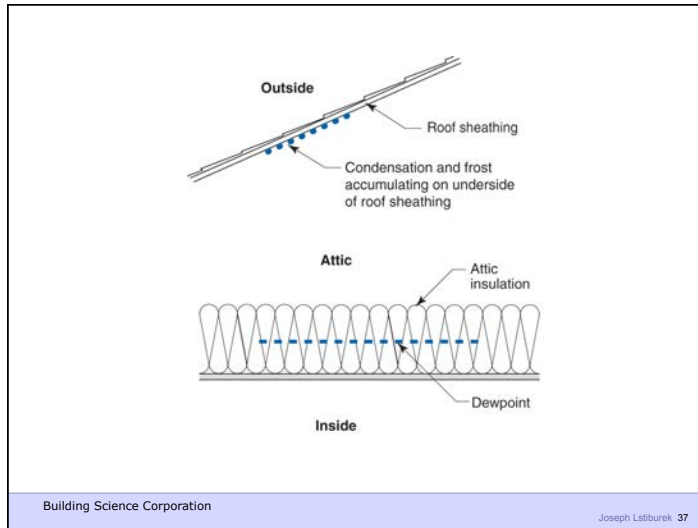

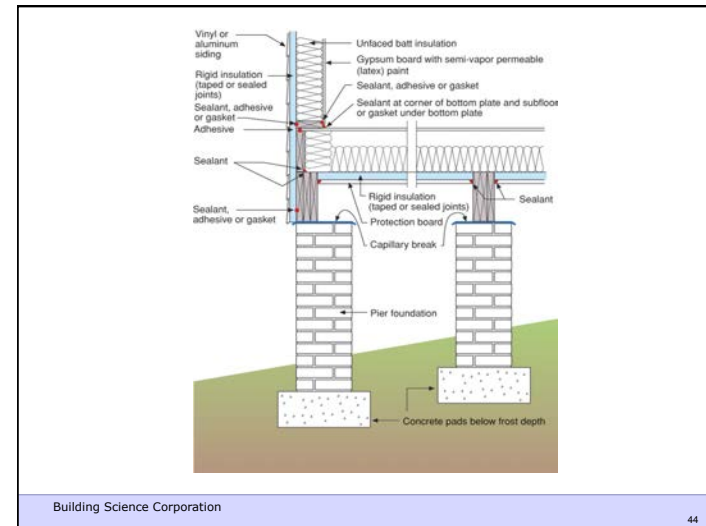
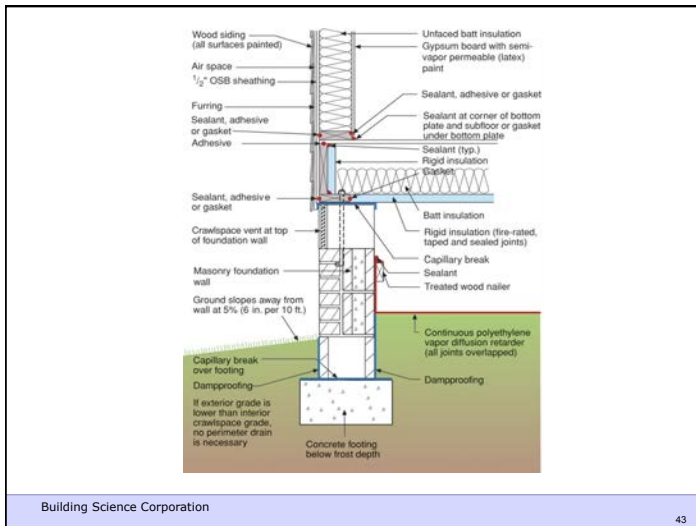
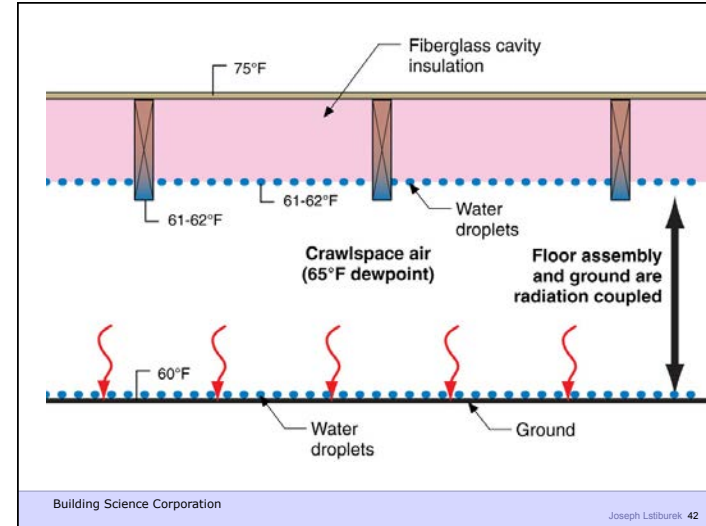

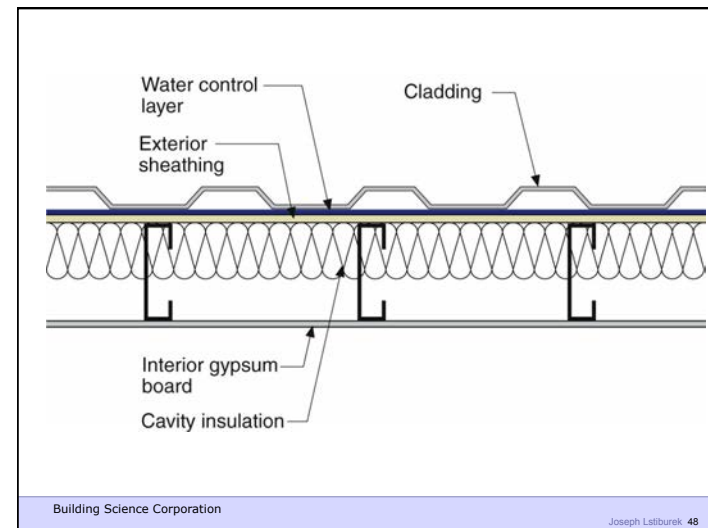
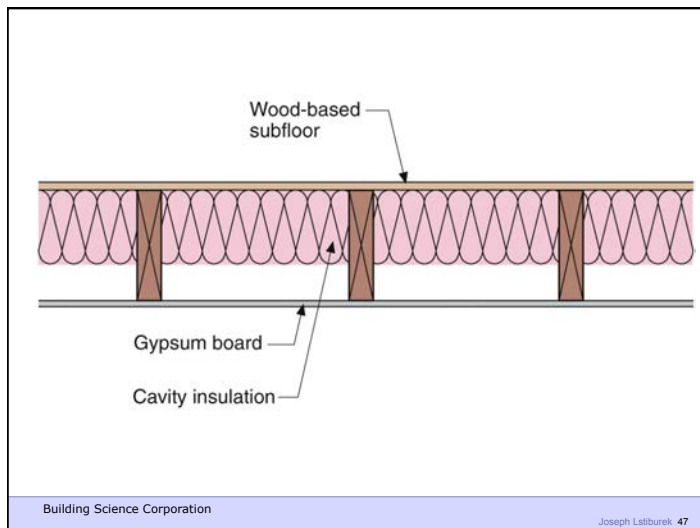
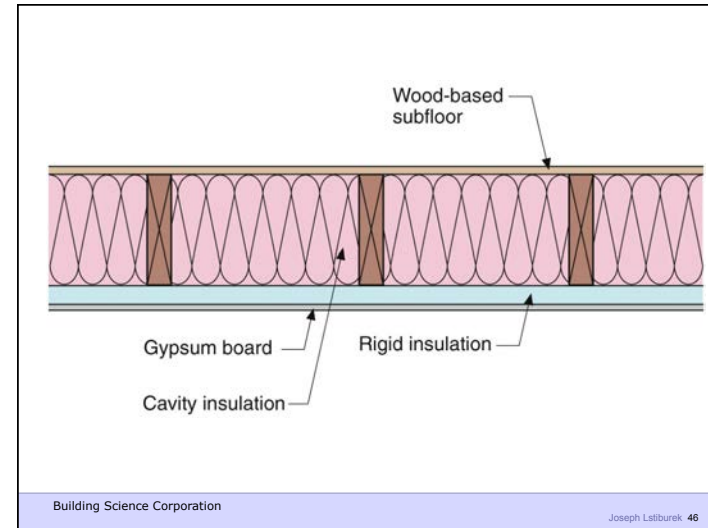
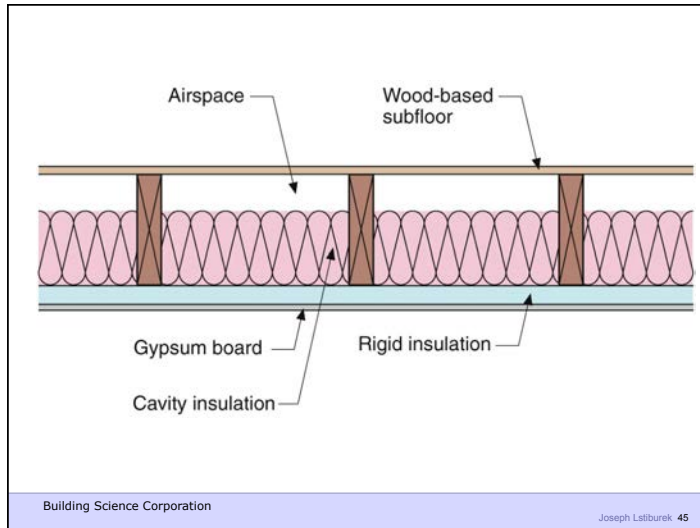

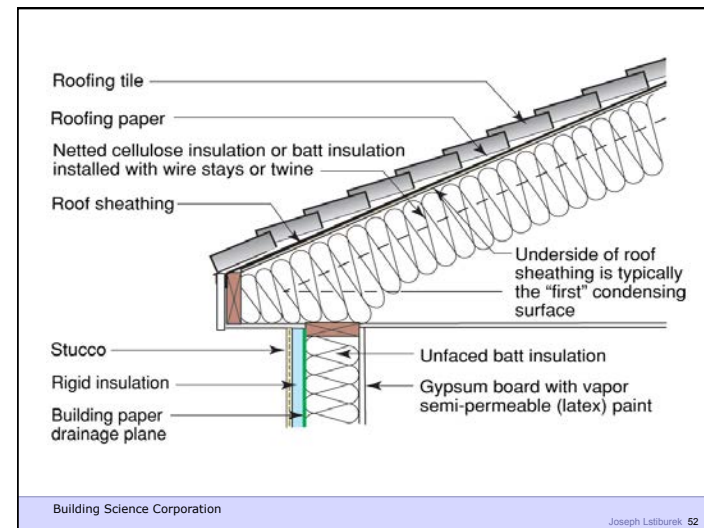
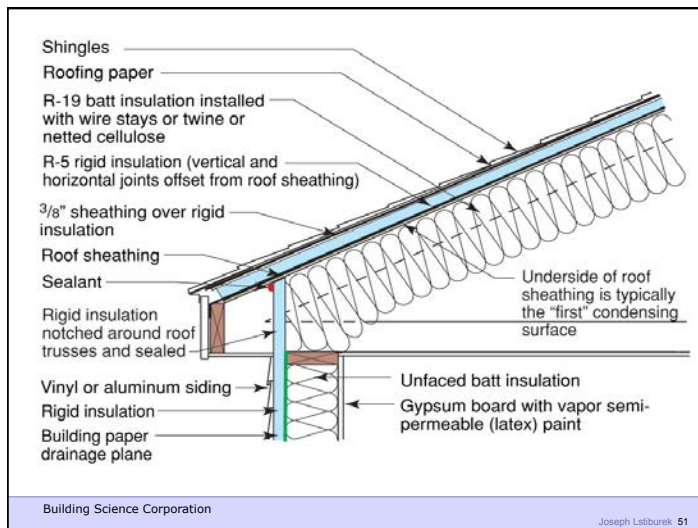
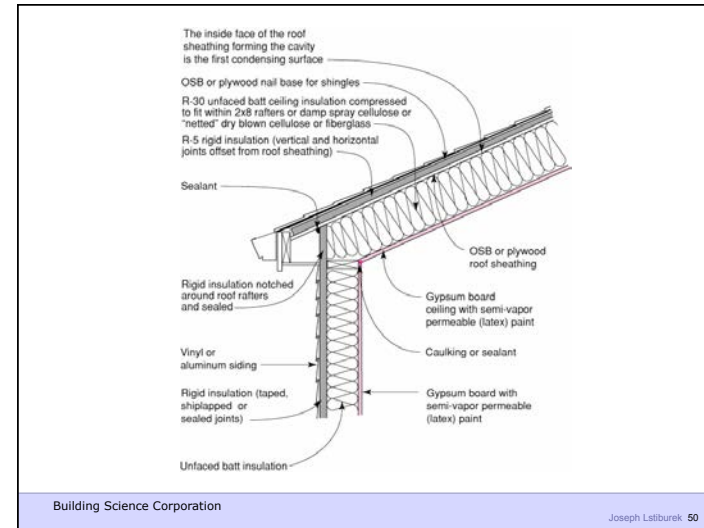
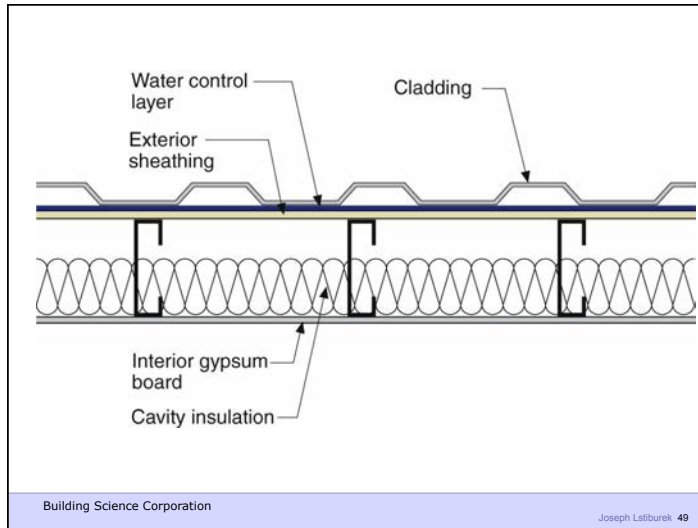

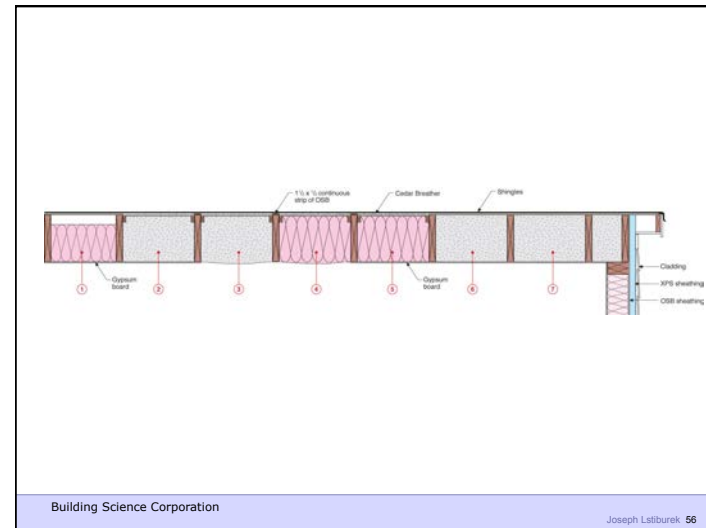
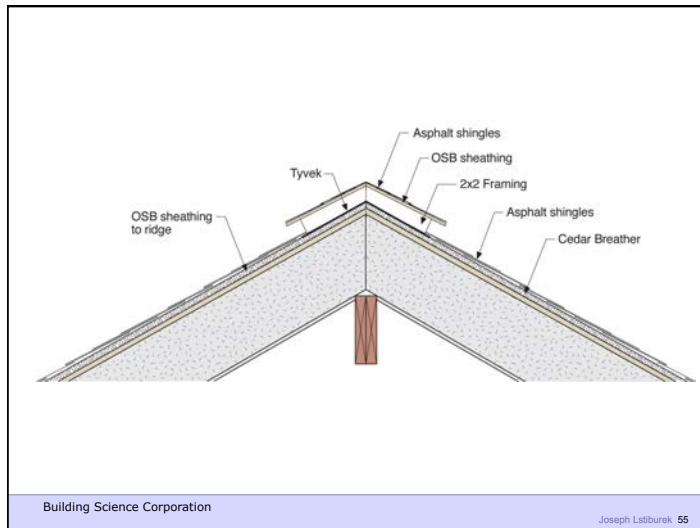
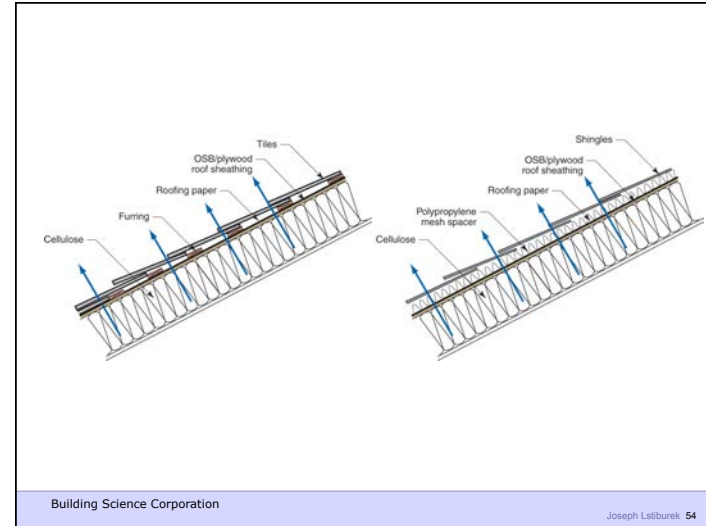

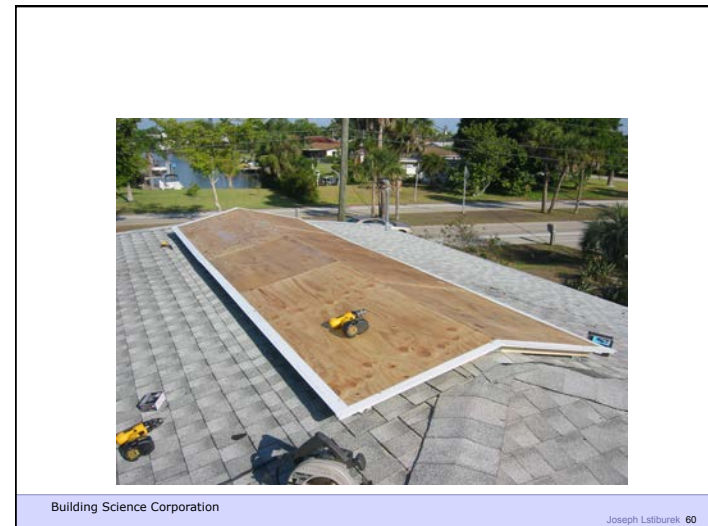
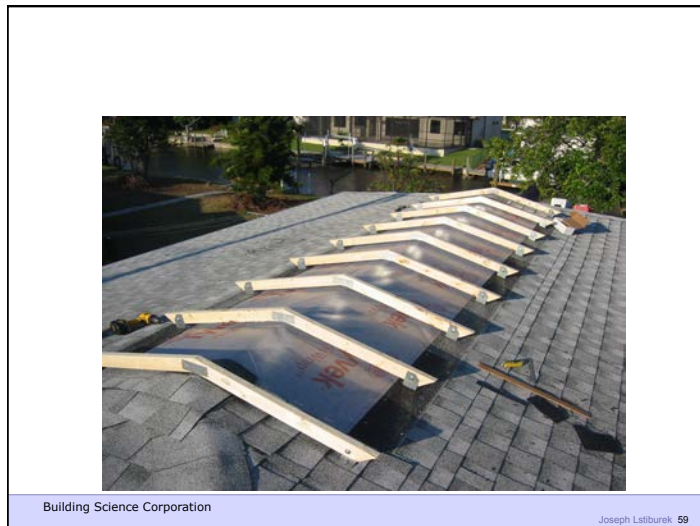

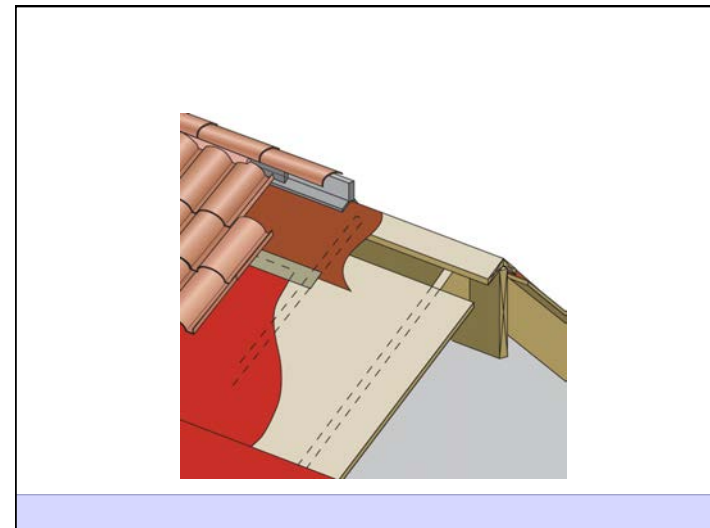
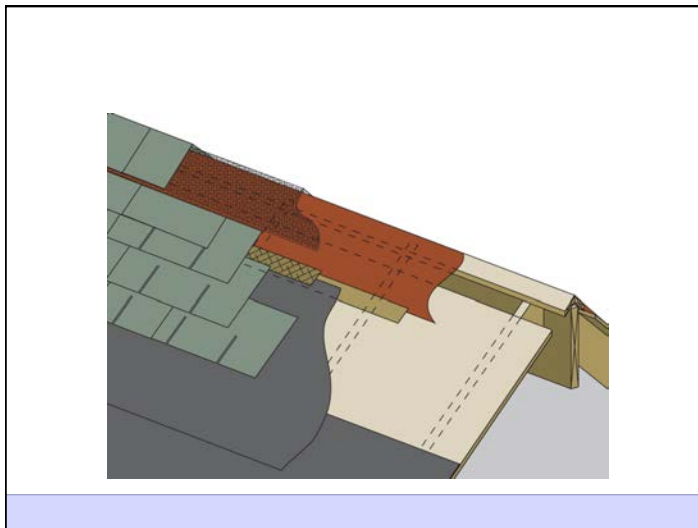

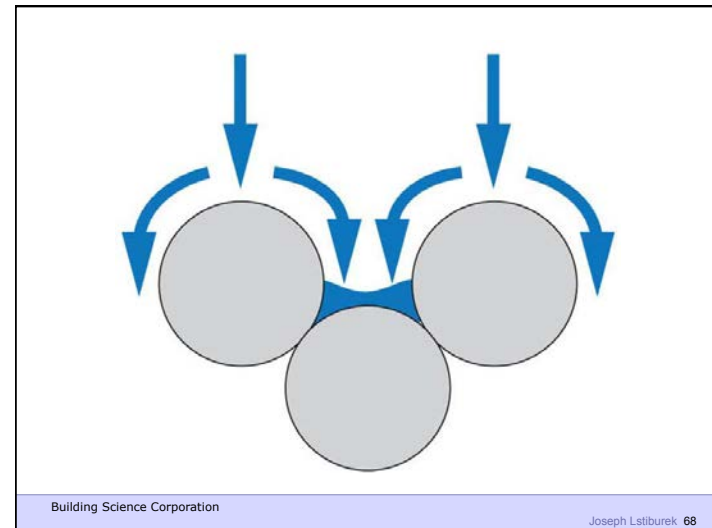
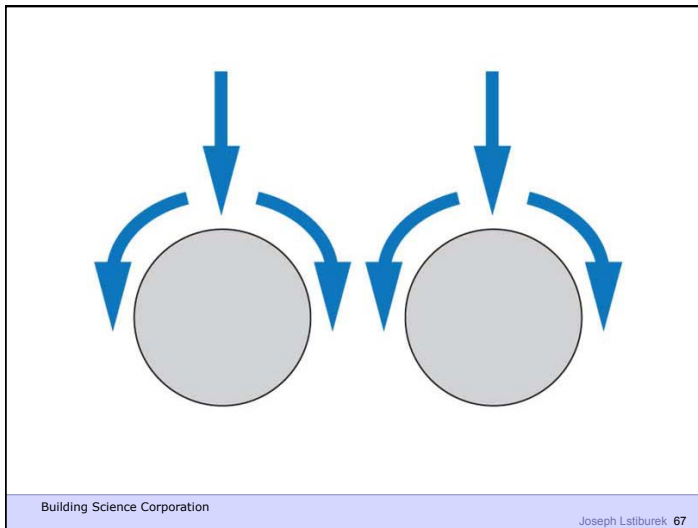
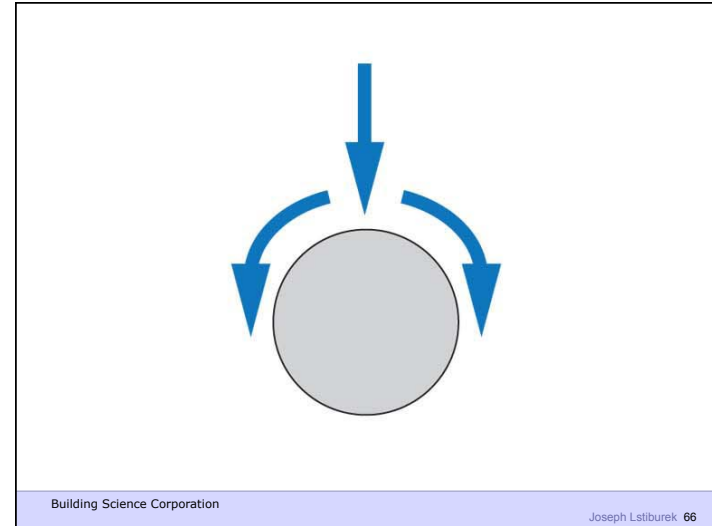
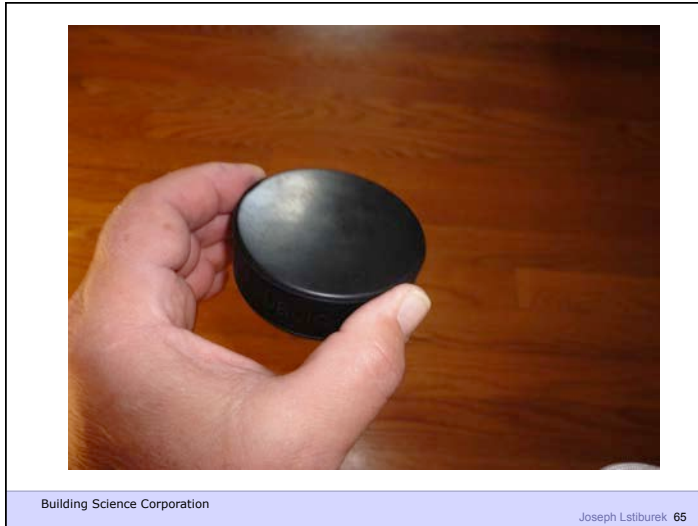

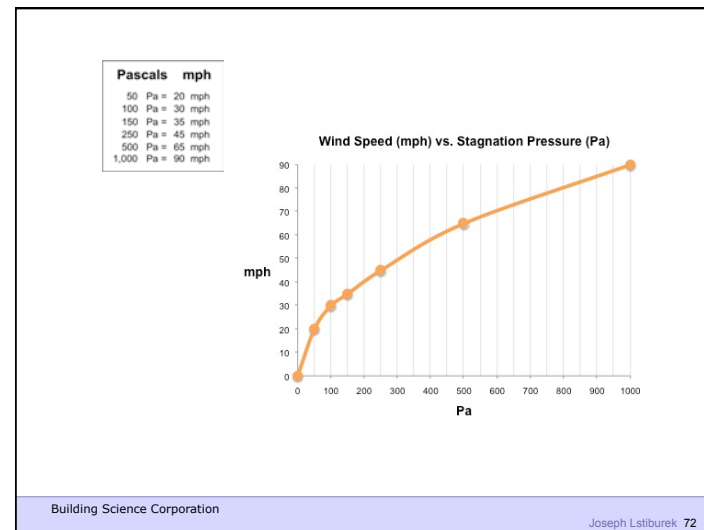
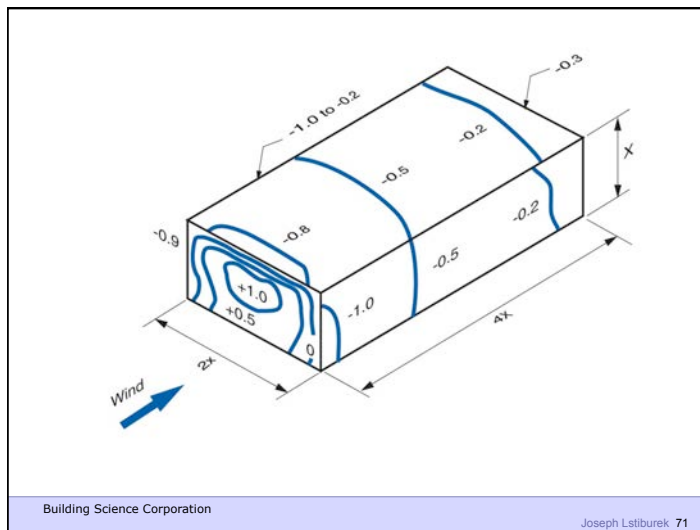
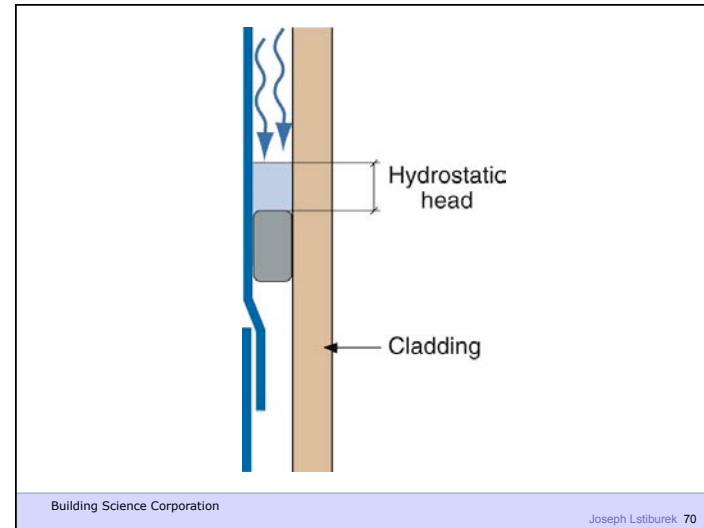
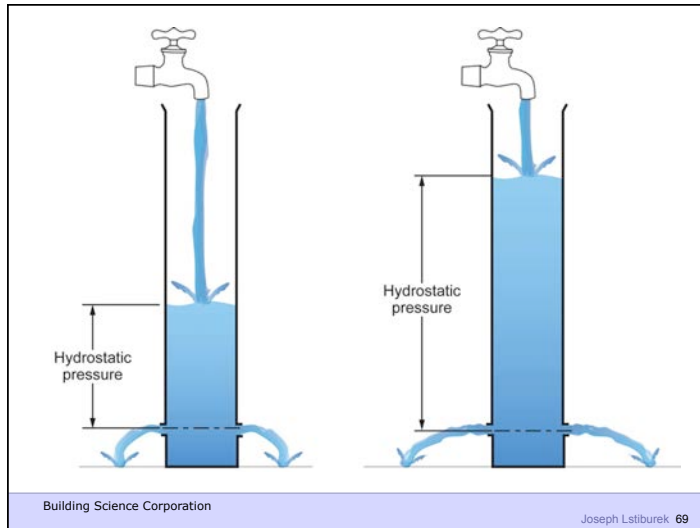

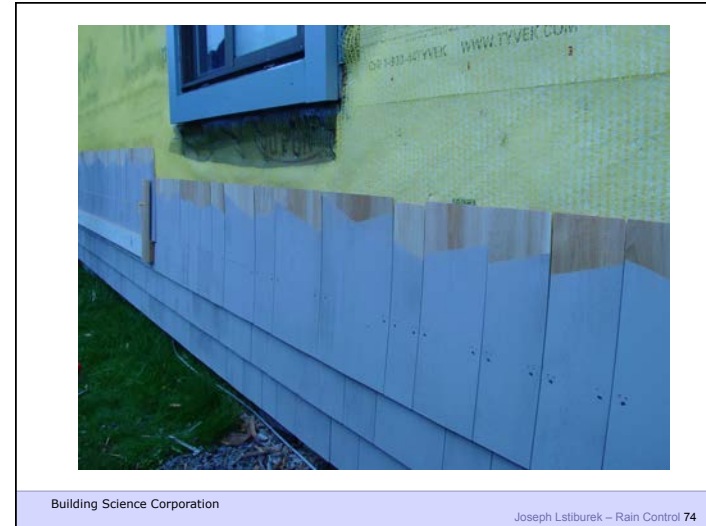

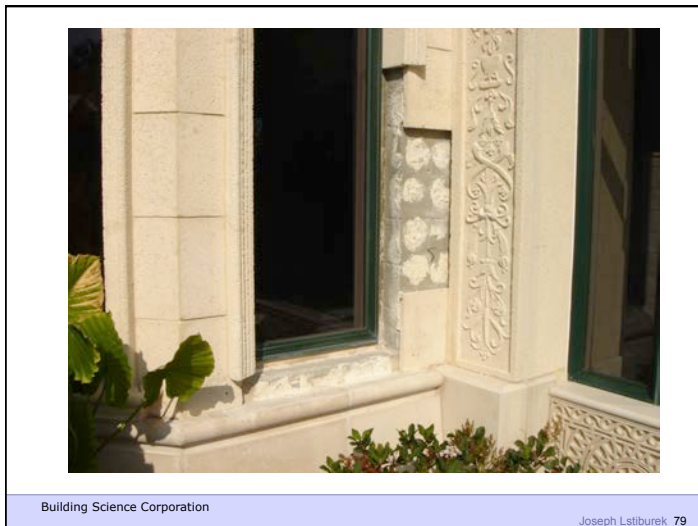
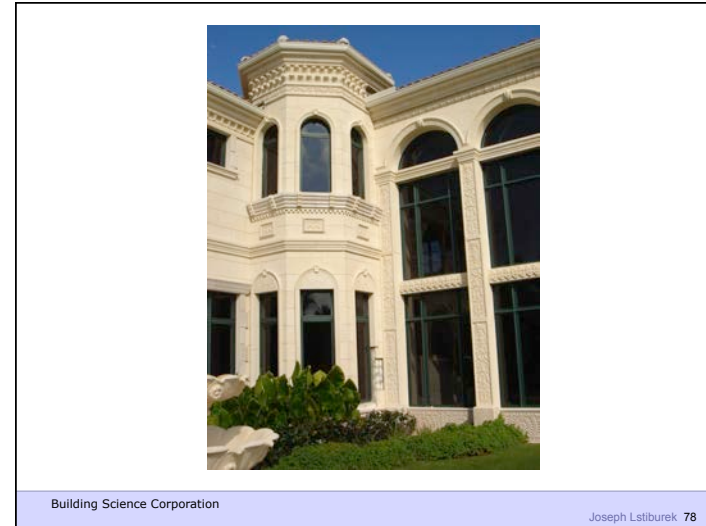

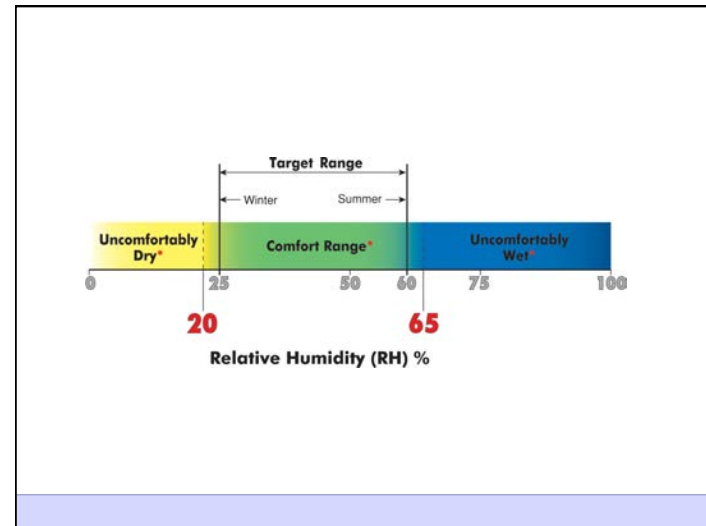
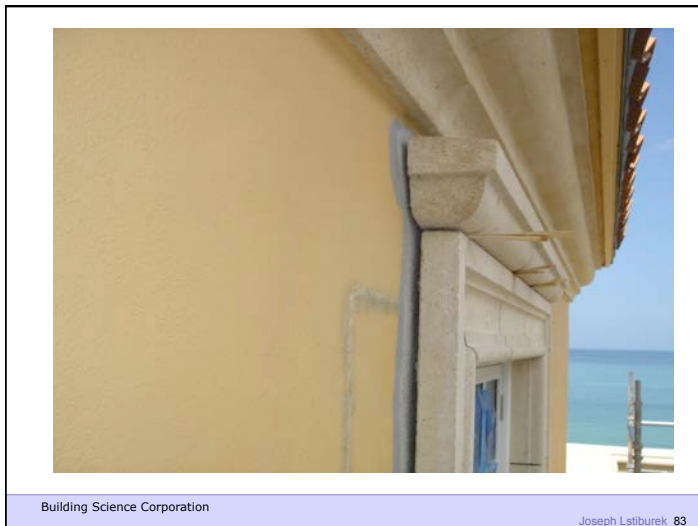
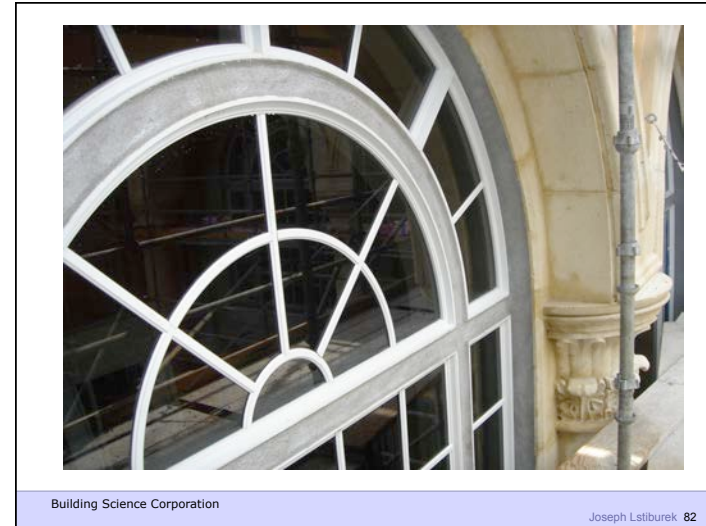

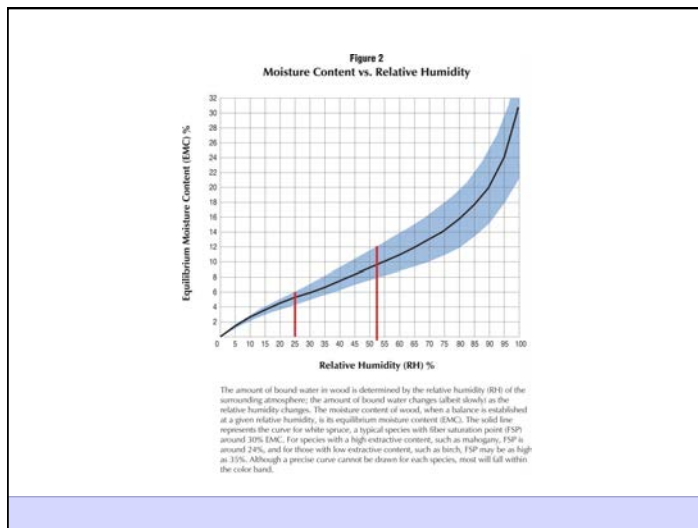
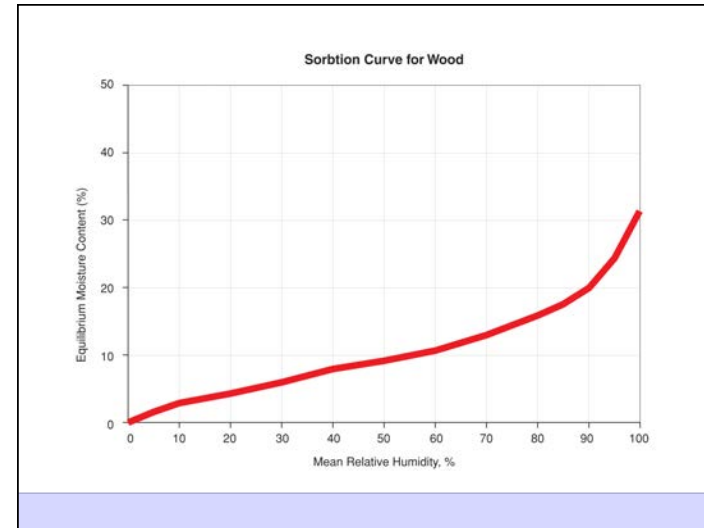
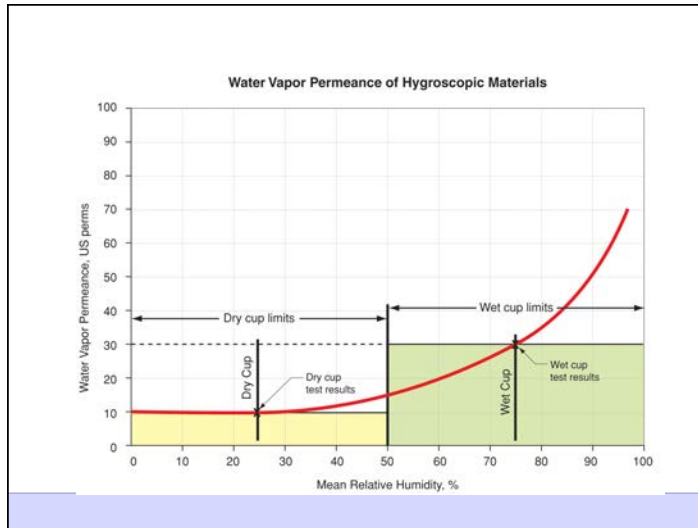

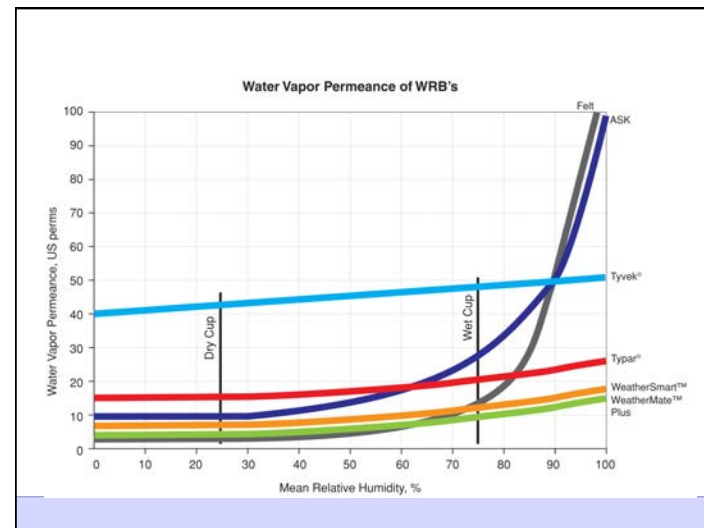
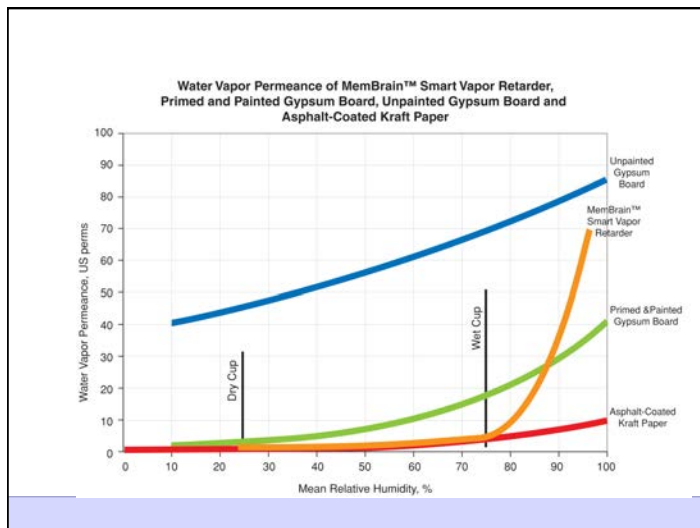
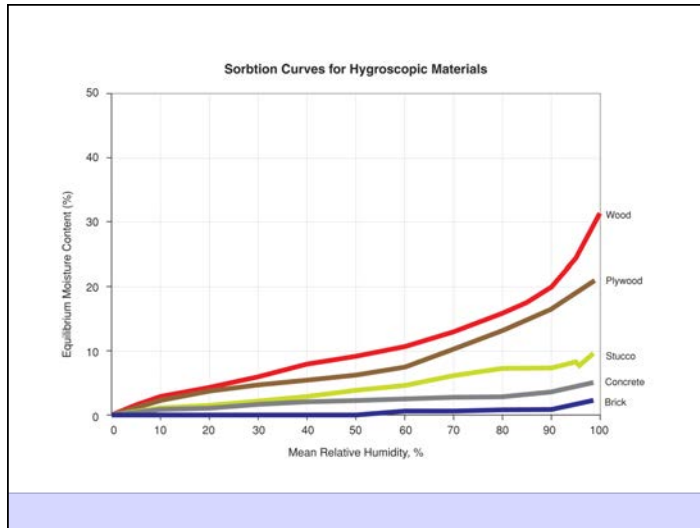

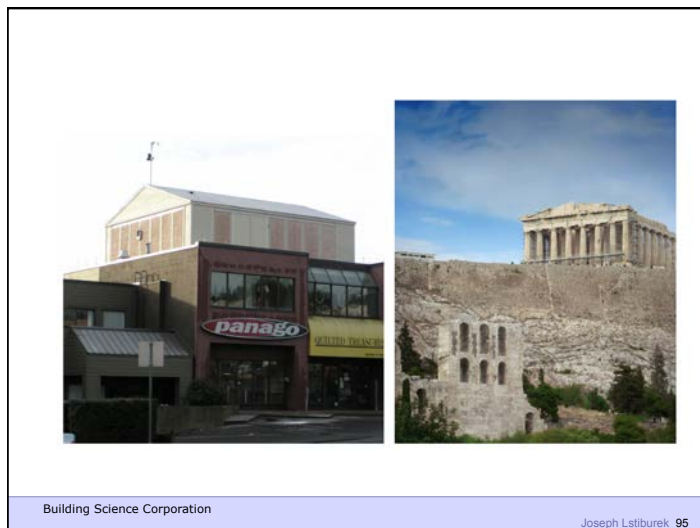
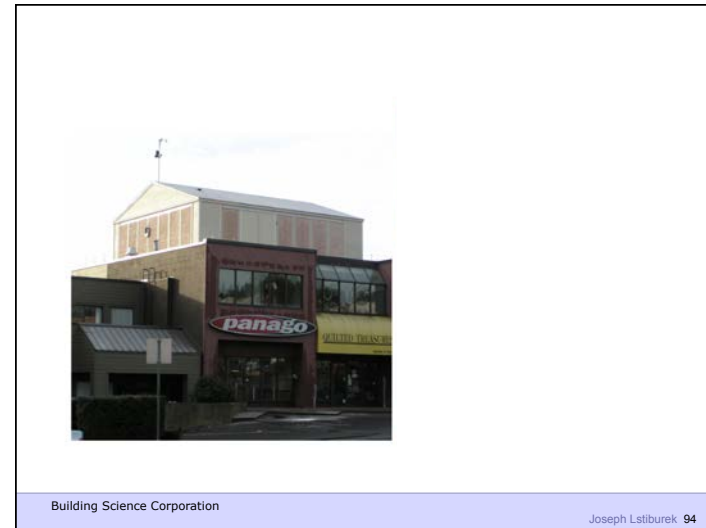
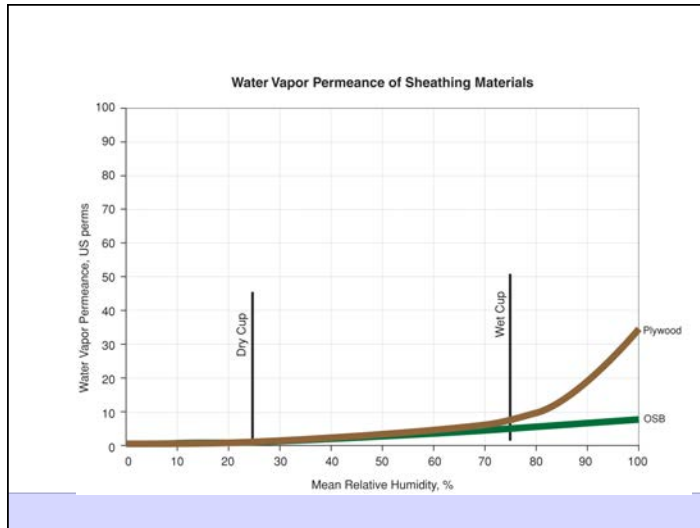

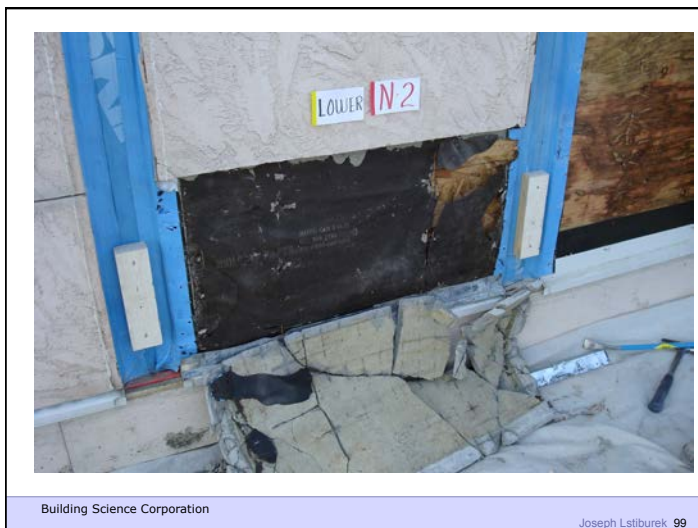
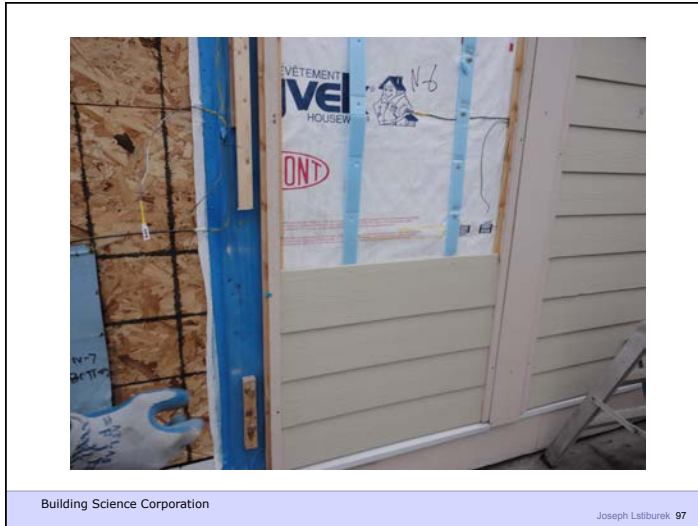

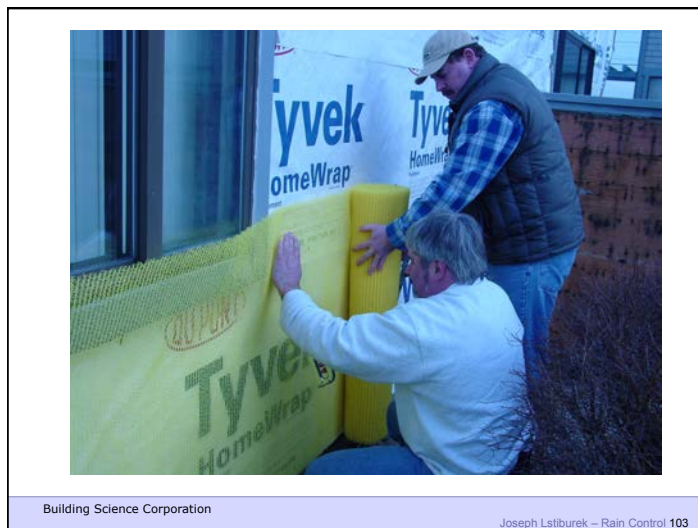
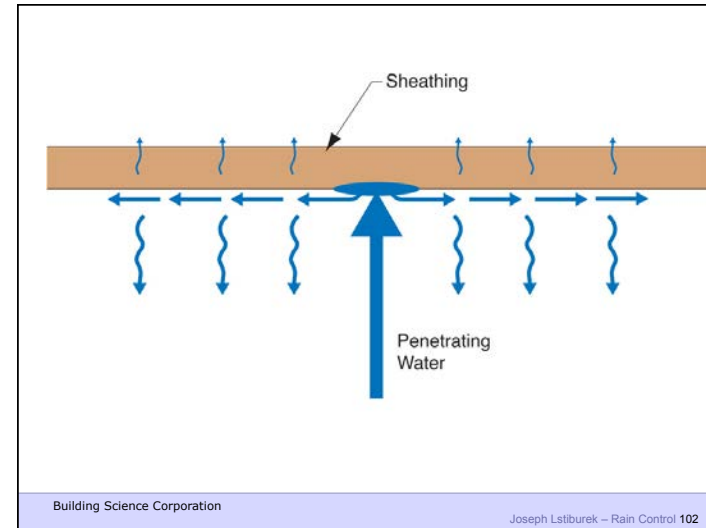
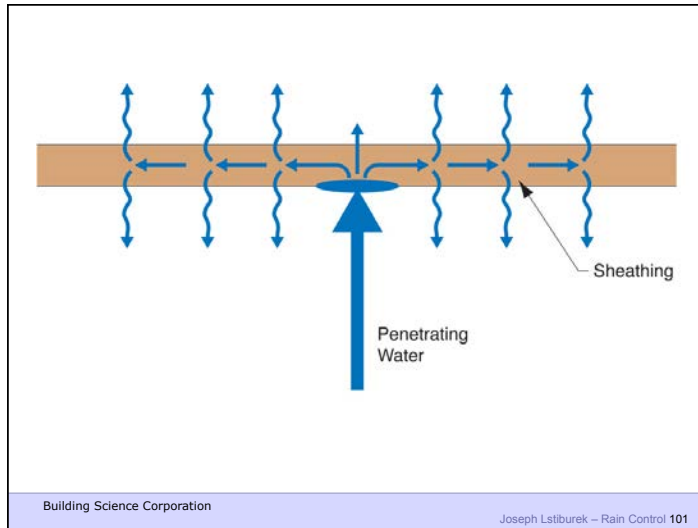

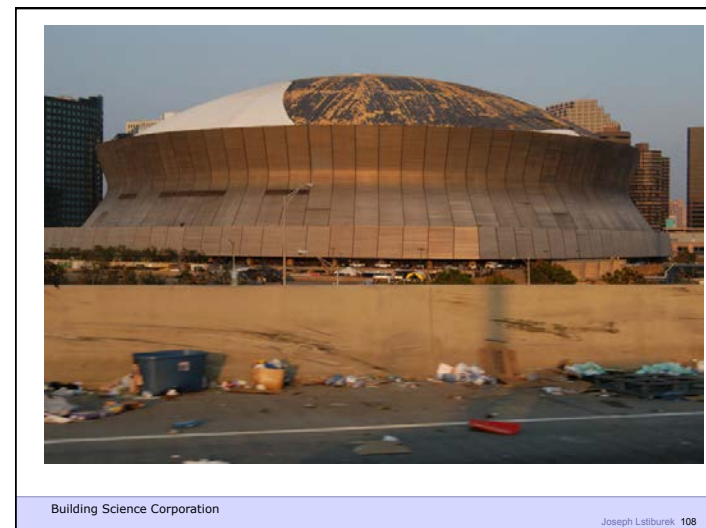
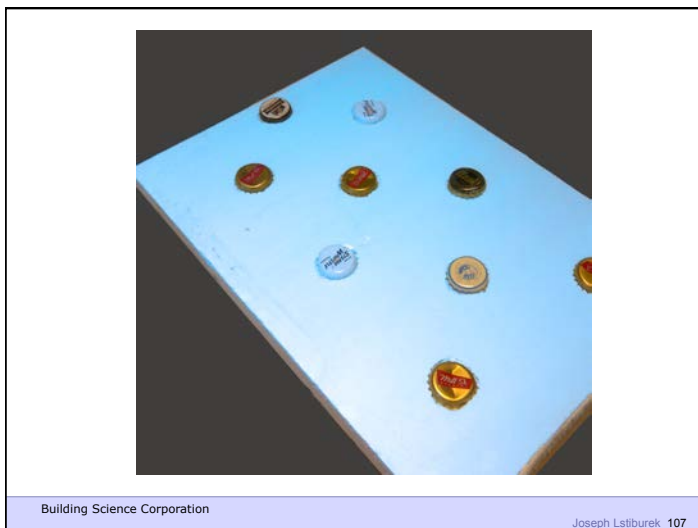
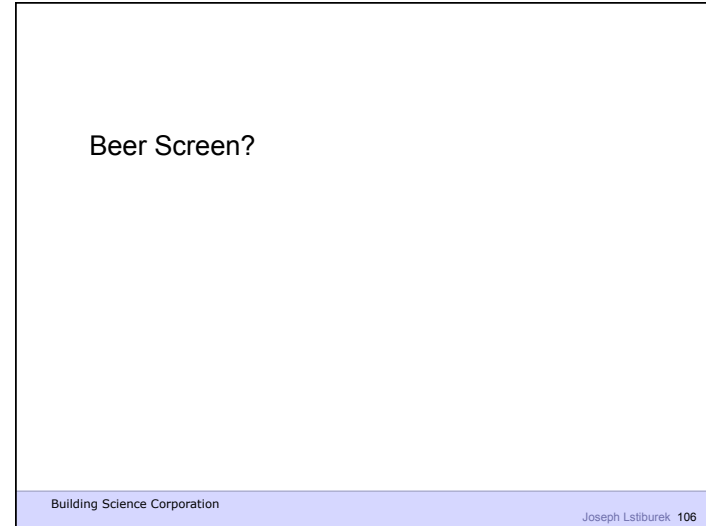
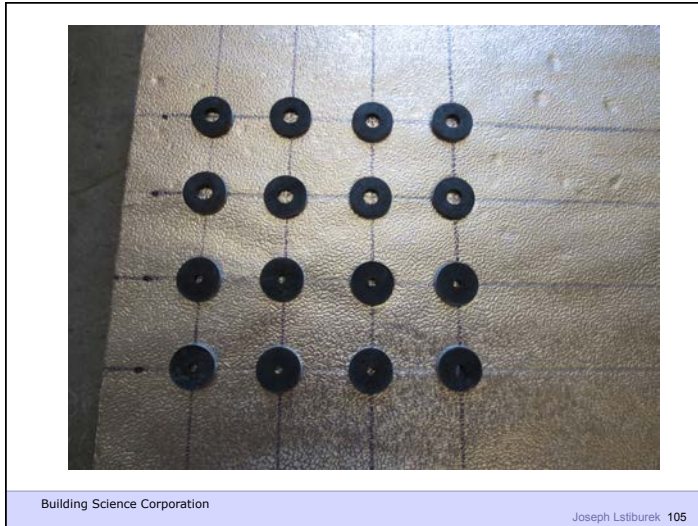

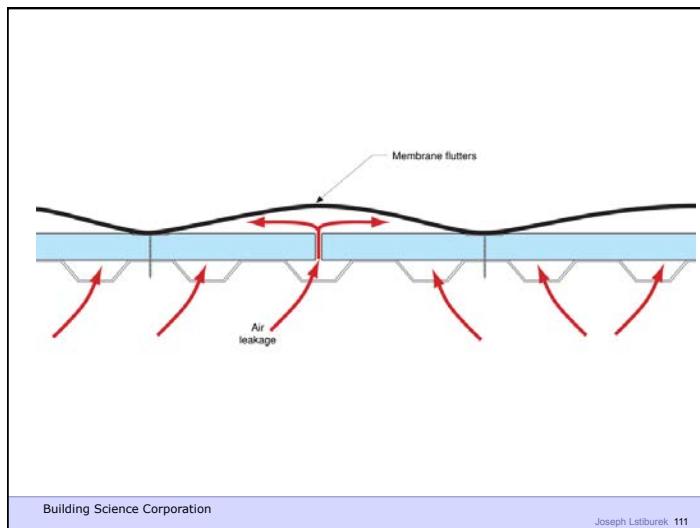
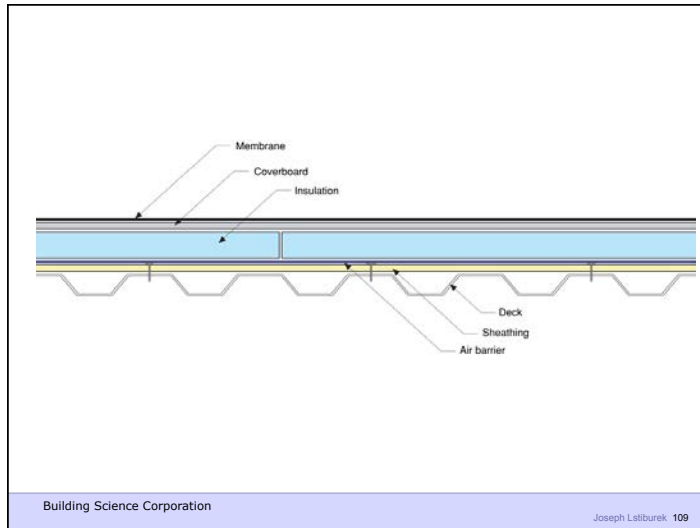

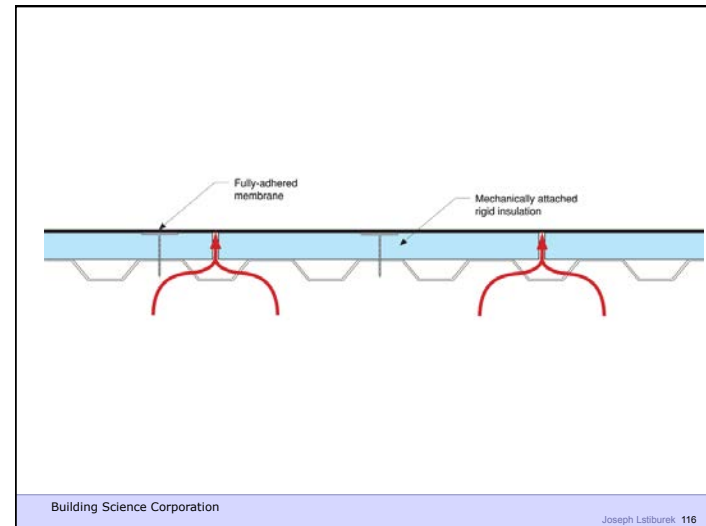
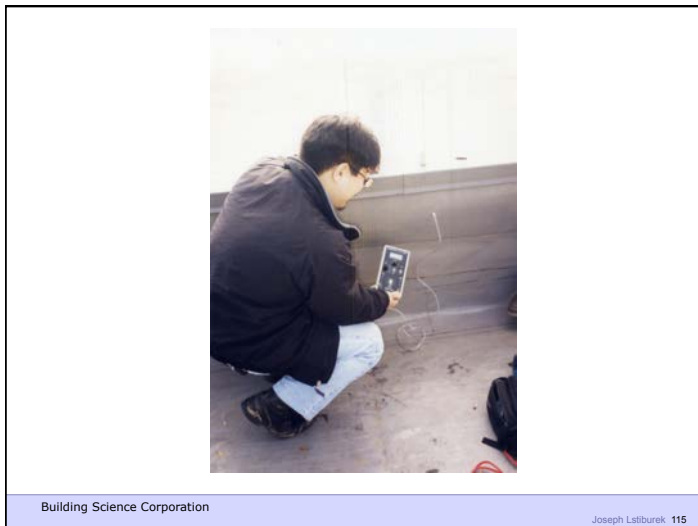
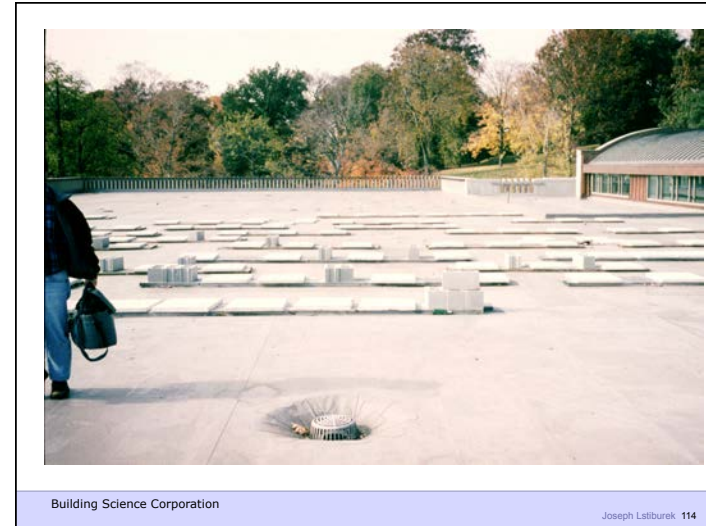

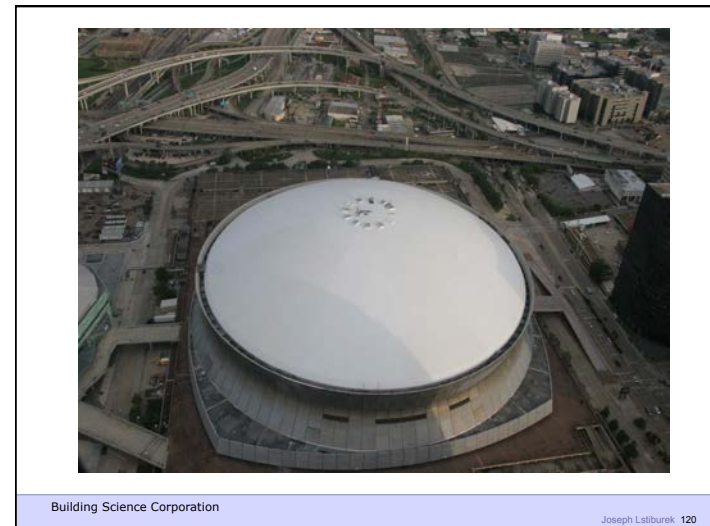
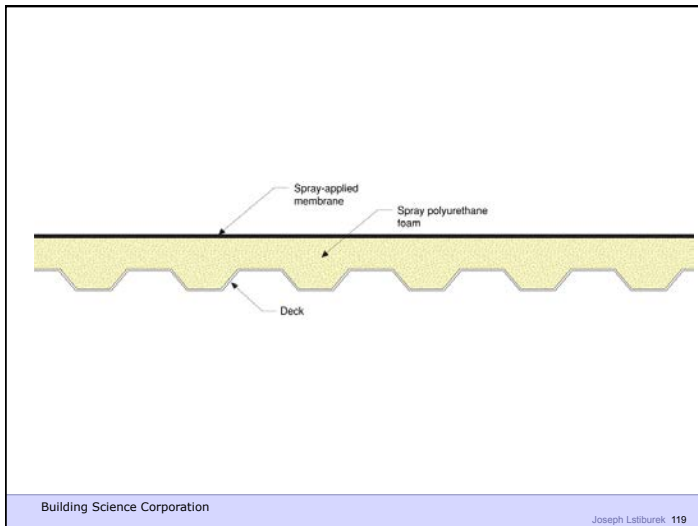
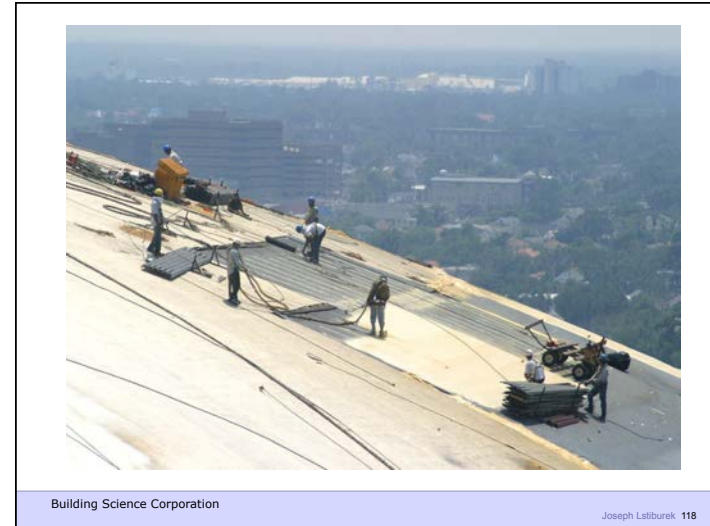
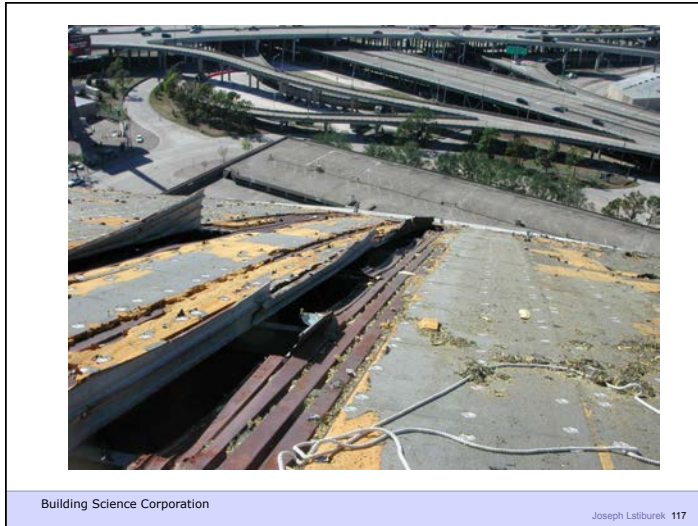

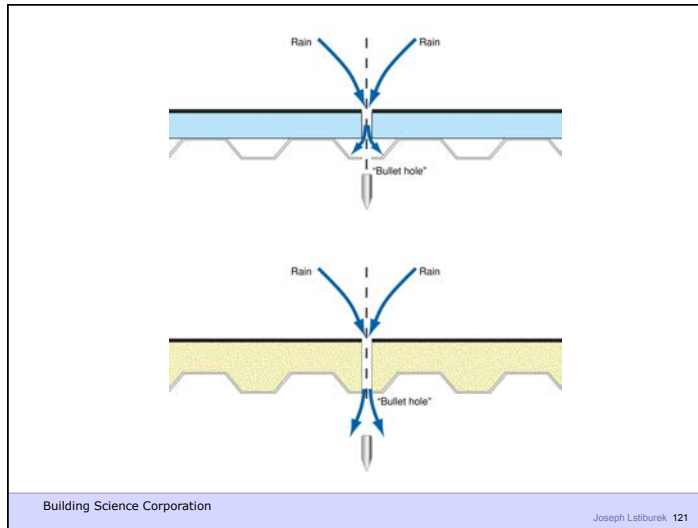

Building Science Corporation

Joseph Lstiburek 121



Building Science Corporation

Joseph Lstiburek 122

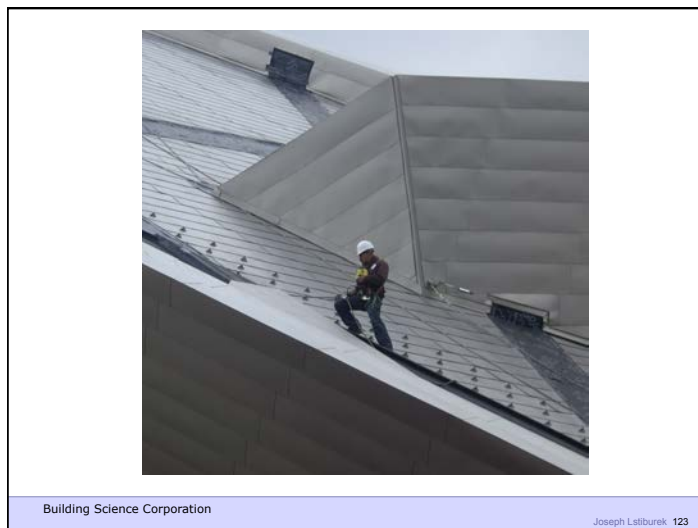

Building Science Corporation

Joseph Lstiburek 123

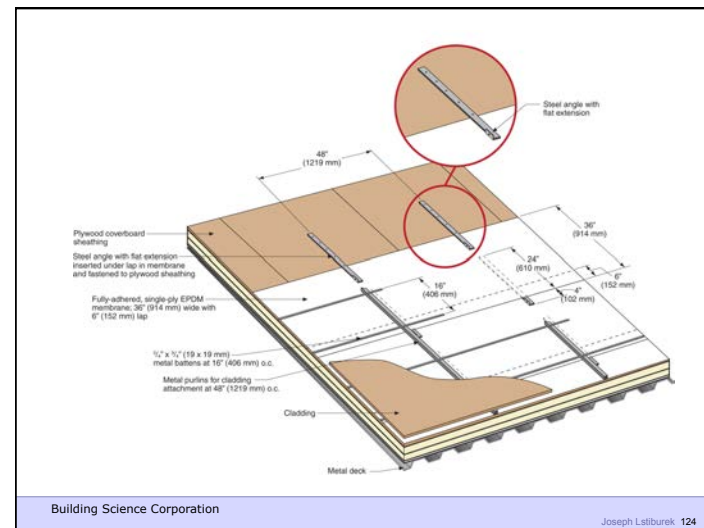

Building Science Corporation

Joseph Lstiburek 124

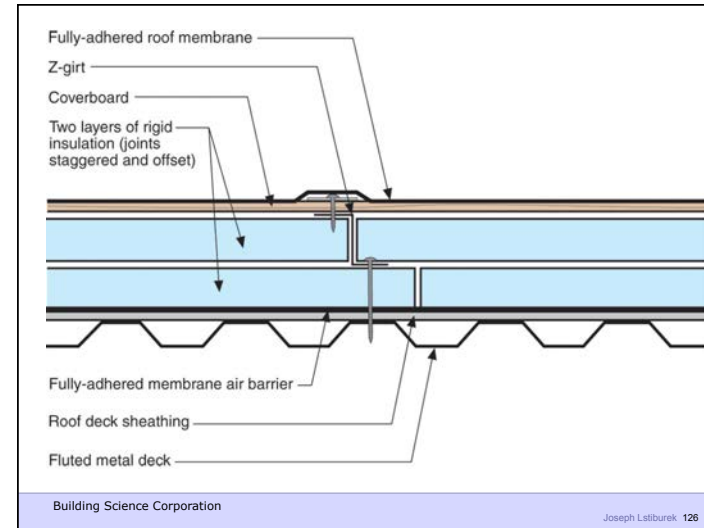
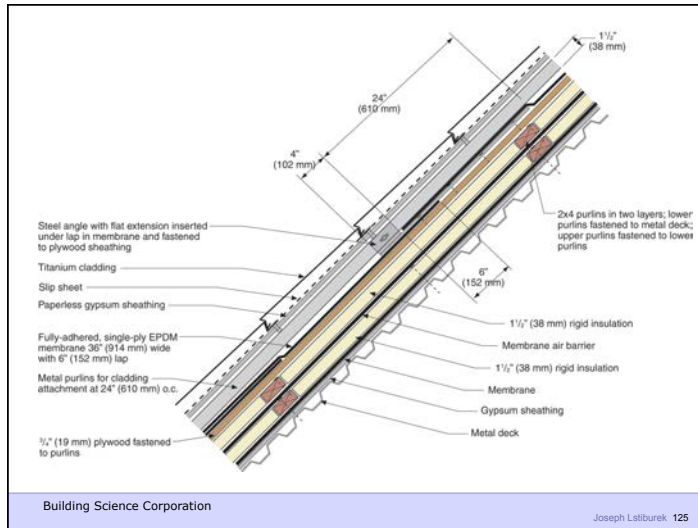

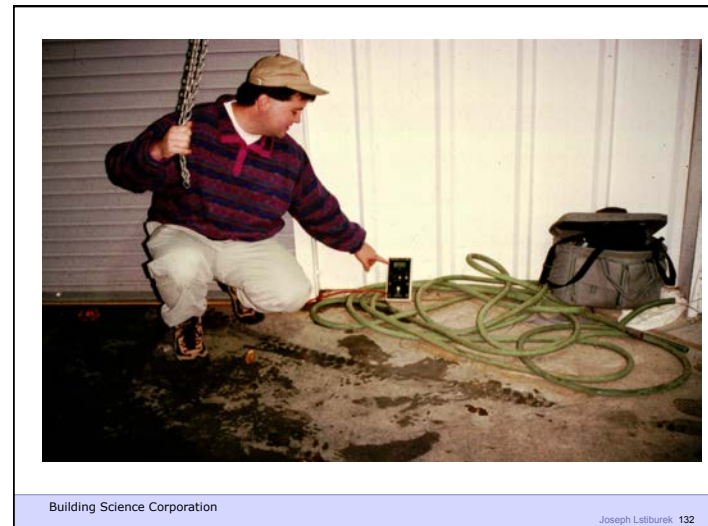
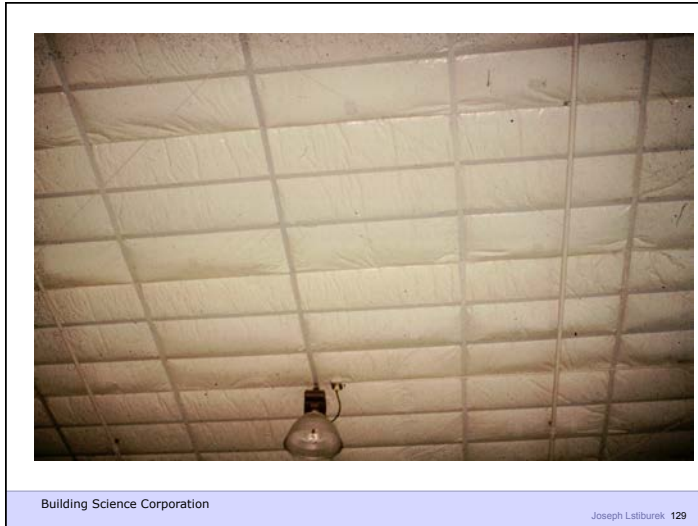

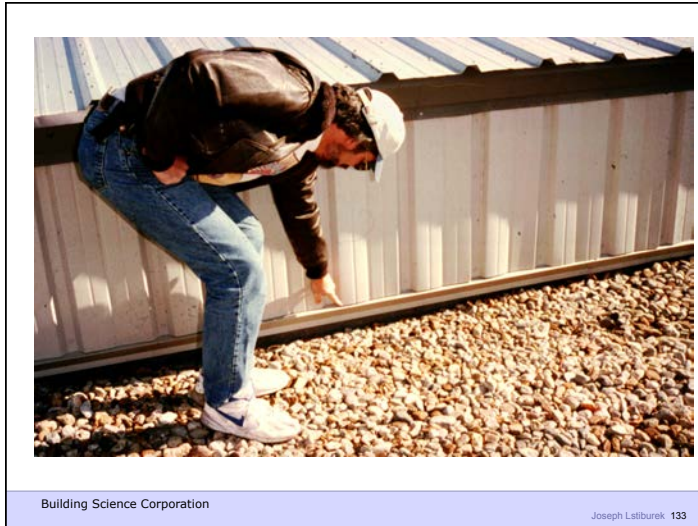

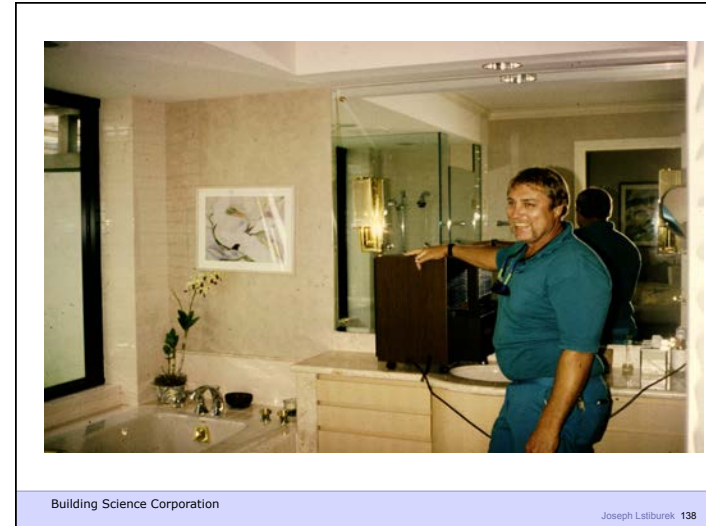
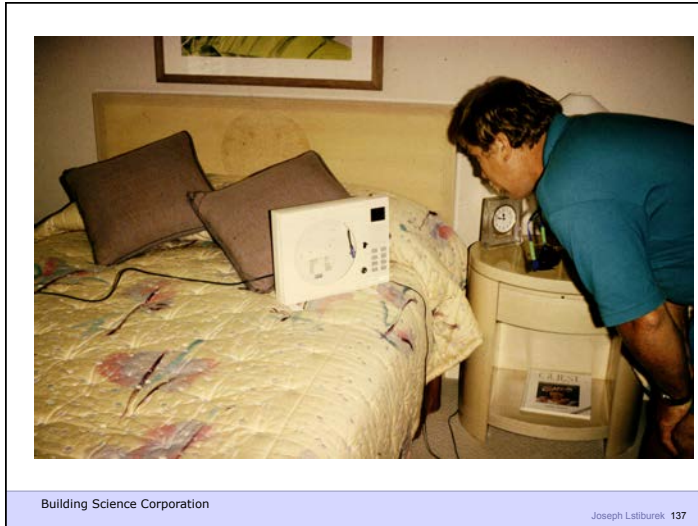

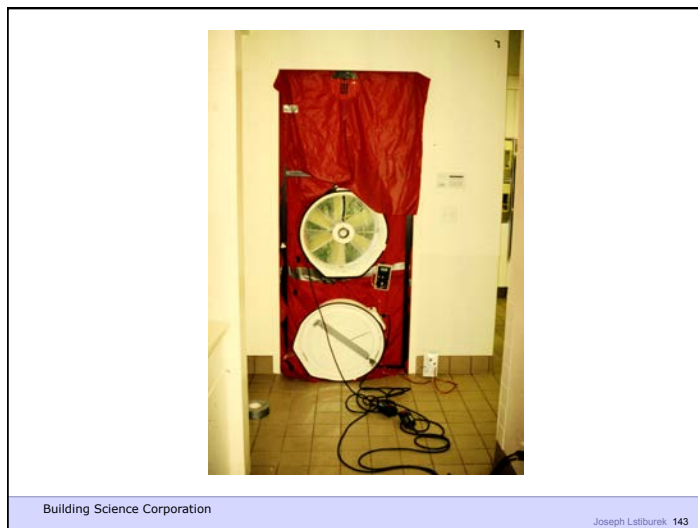
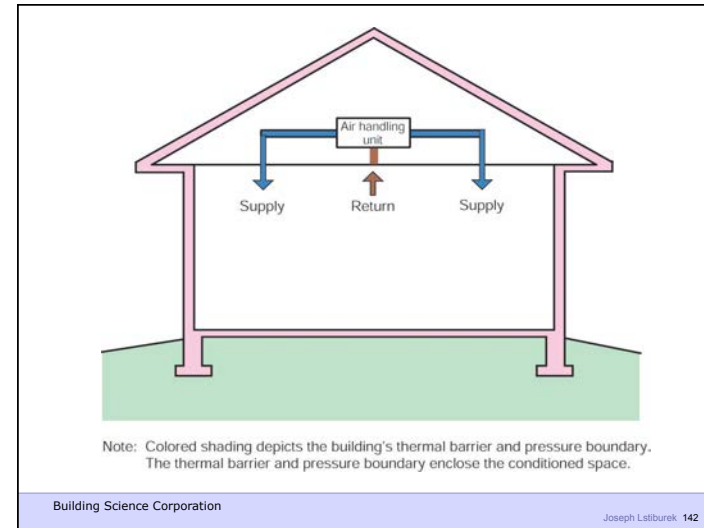
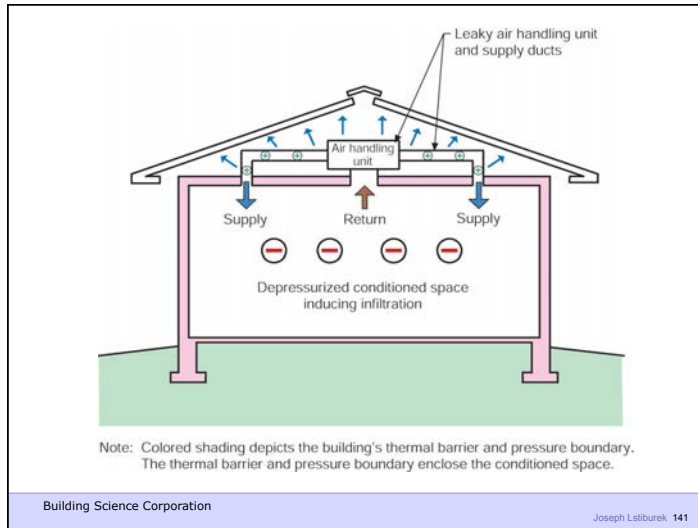

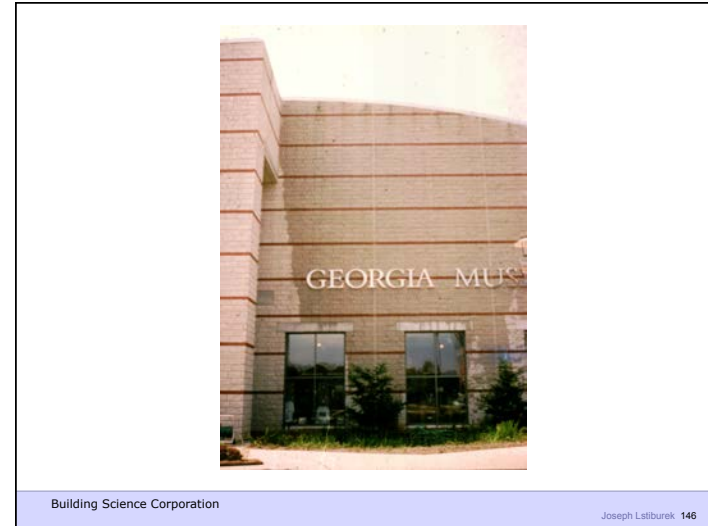
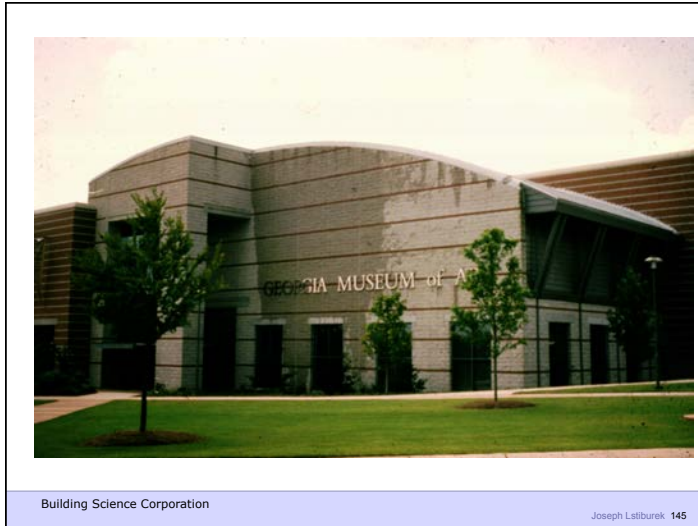

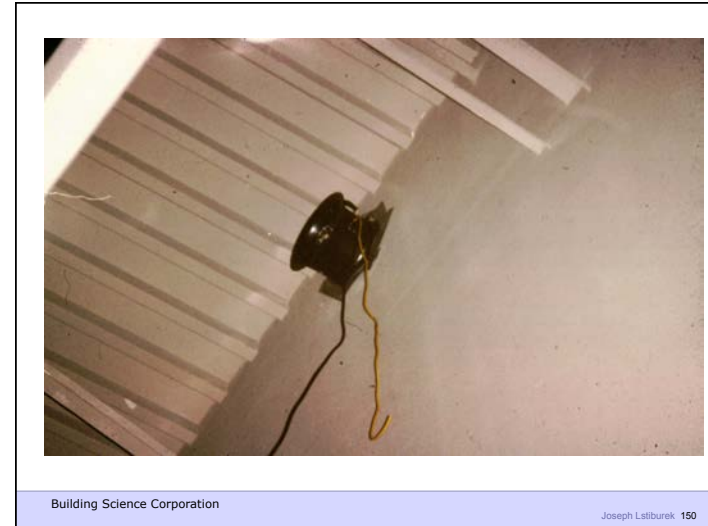
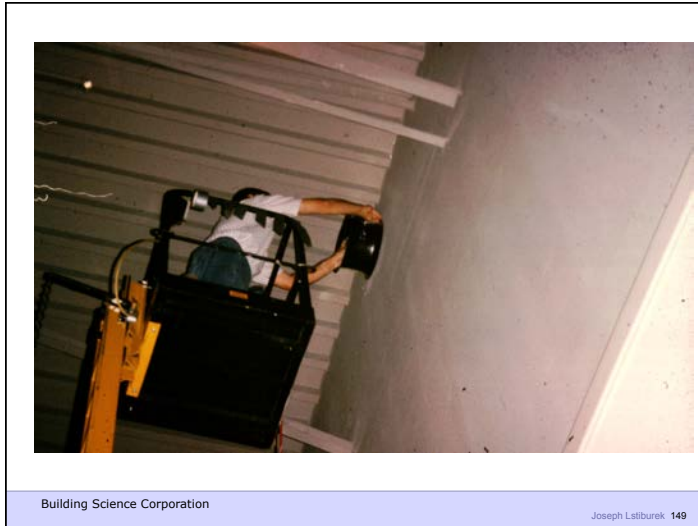

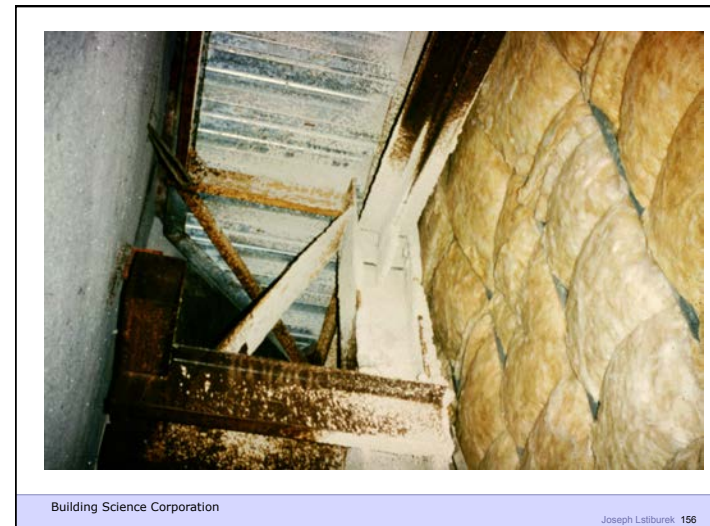

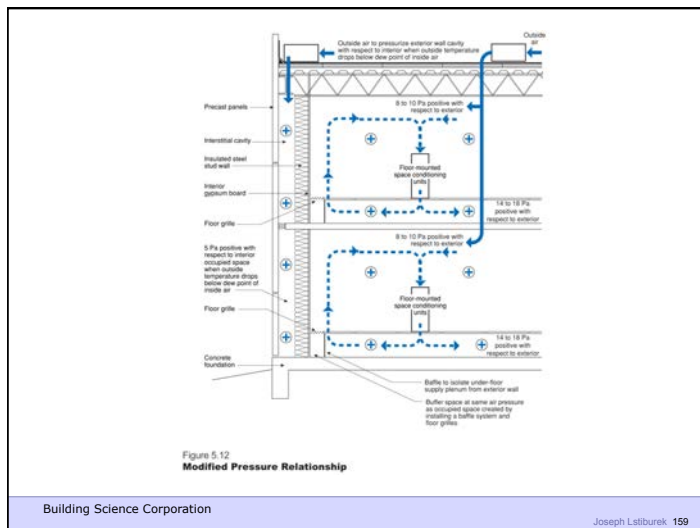
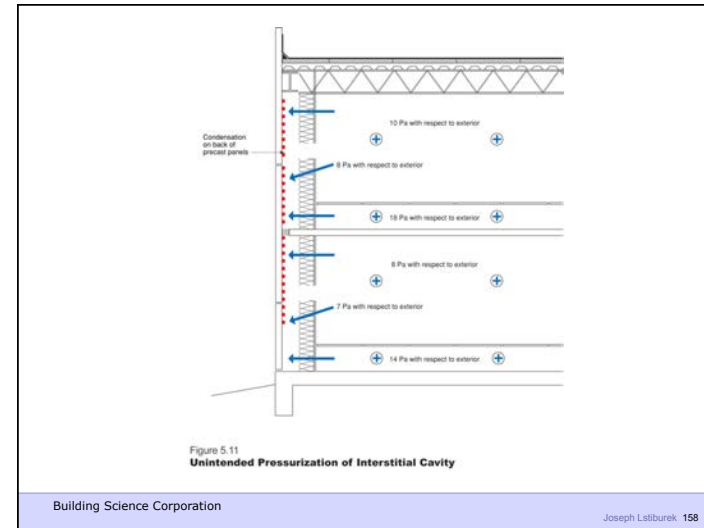
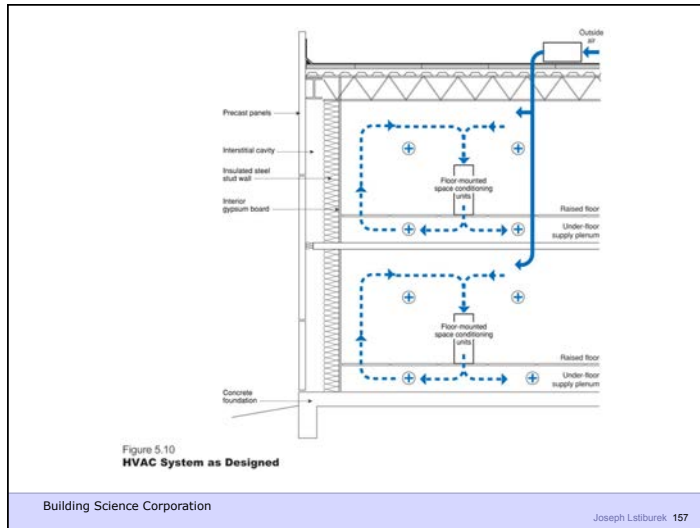

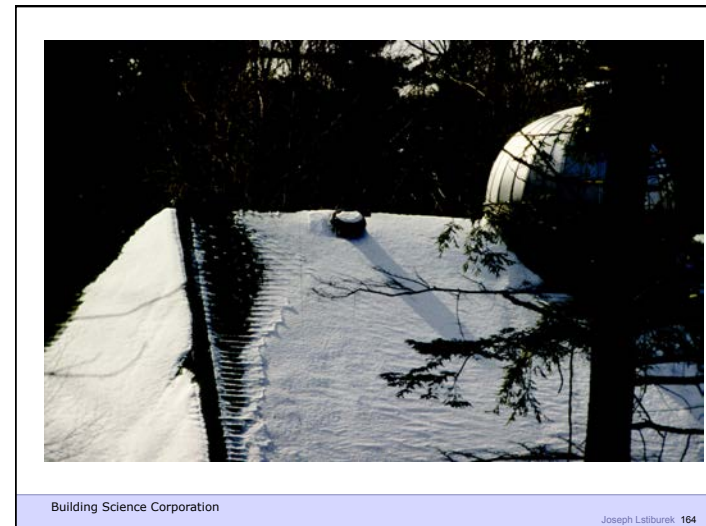

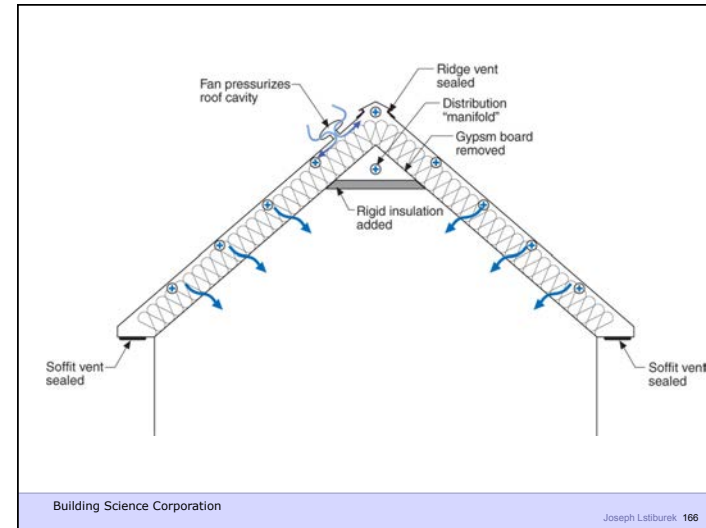
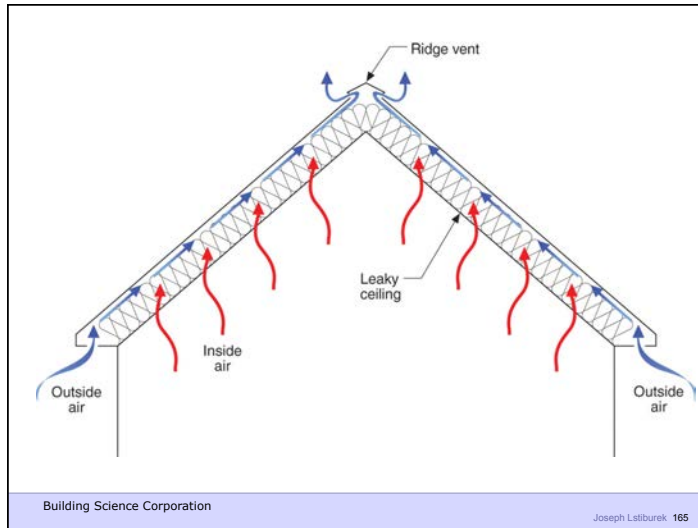

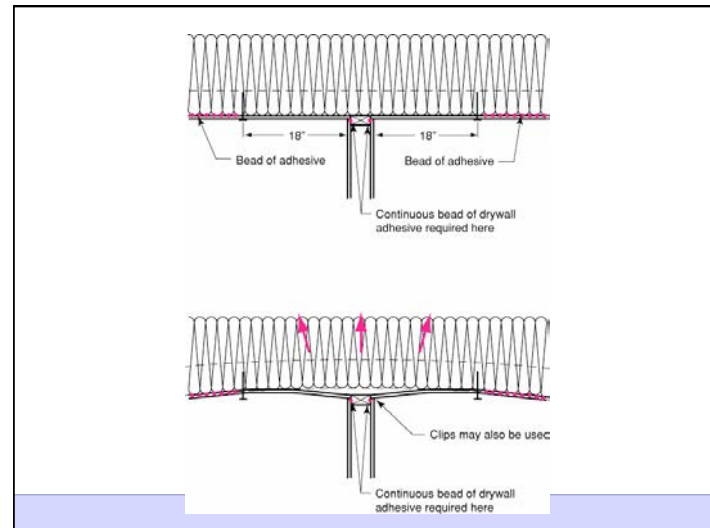

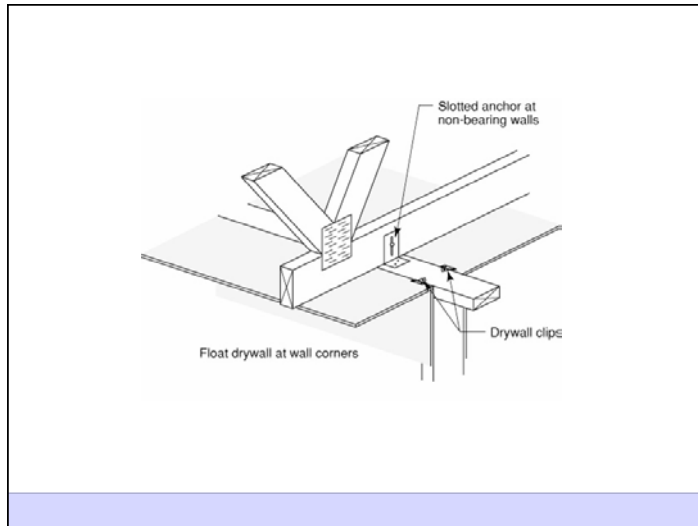

Building Science Corporation

Joseph Lstiburek 174



Building Science Corporation

Joseph Lstiburek 175



Building Science Corporation

Joseph Lstiburek 176

