

Joseph Lstiburek, Ph.D., P.Eng, ASHRAE Fellow

Building Science

Adventures In Building Science

www.buildingscience.com

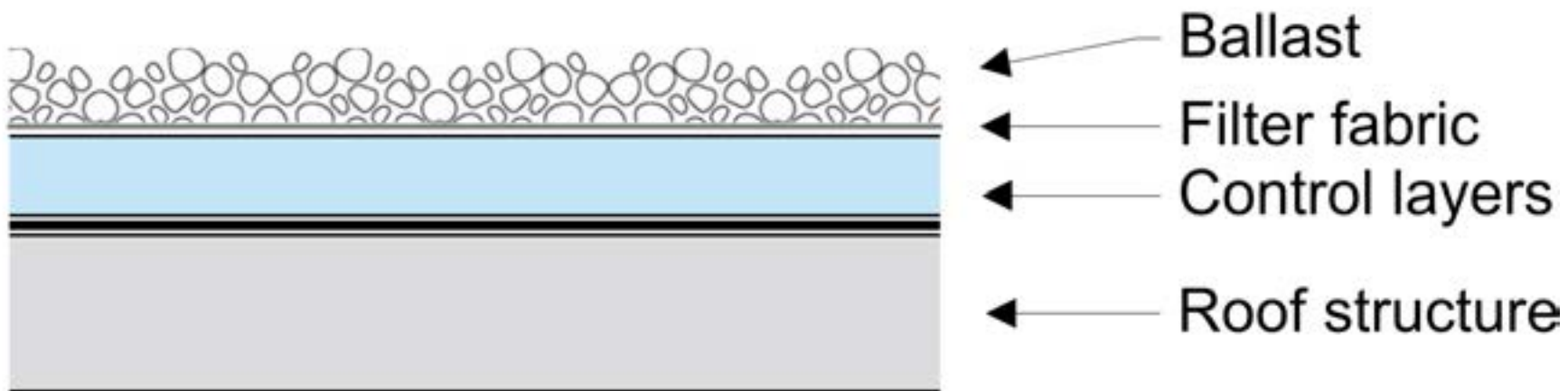

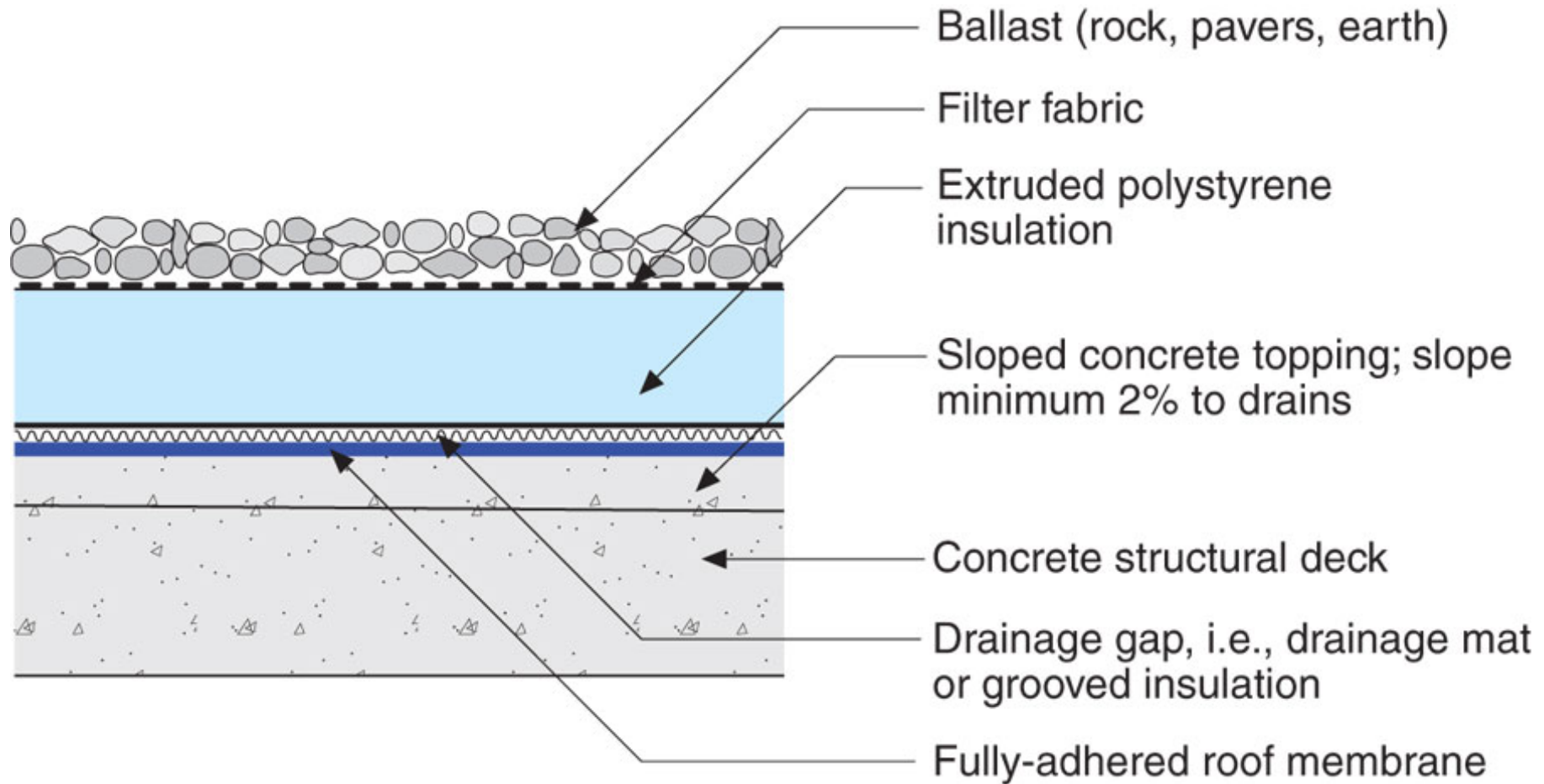

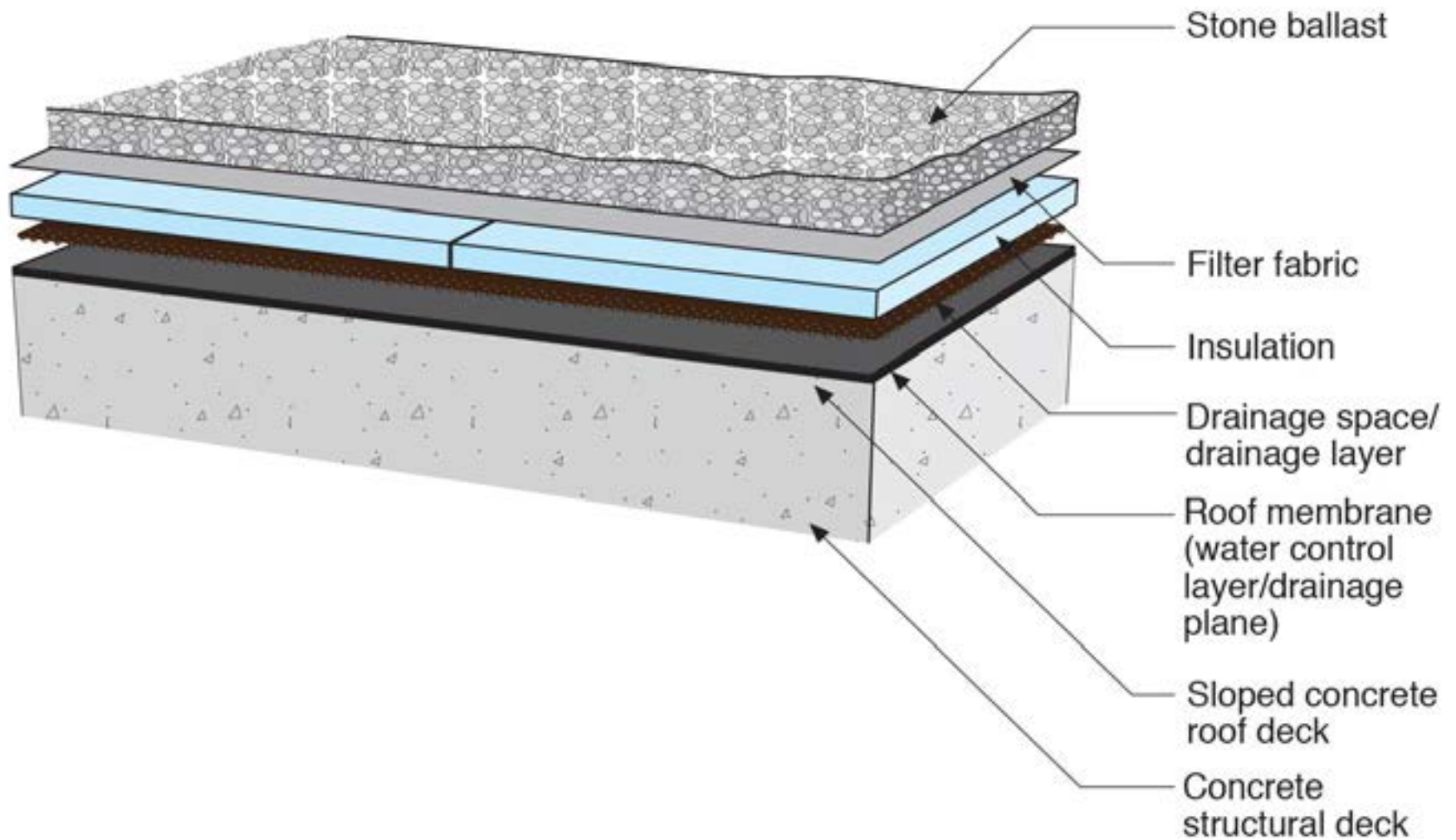

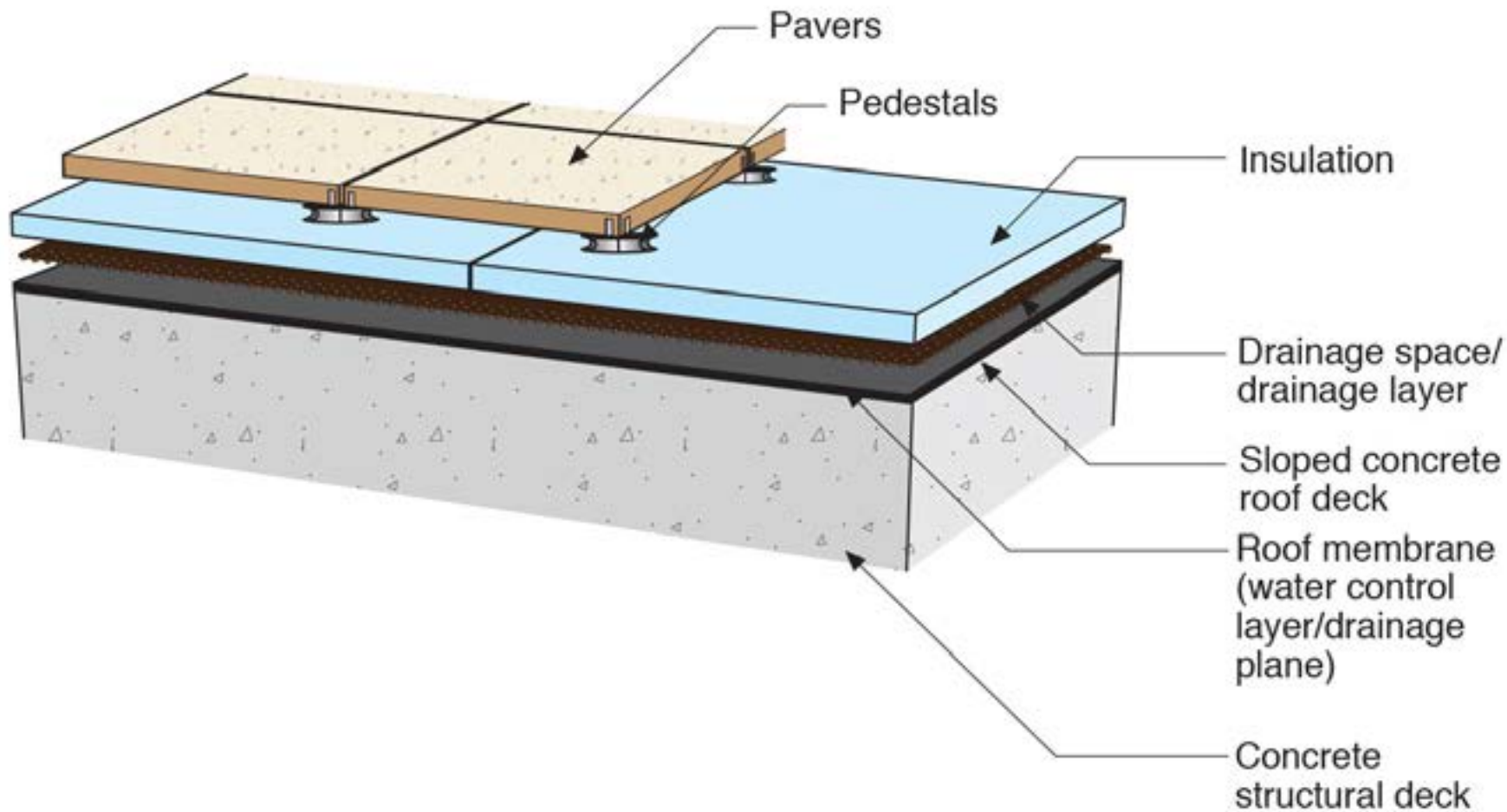

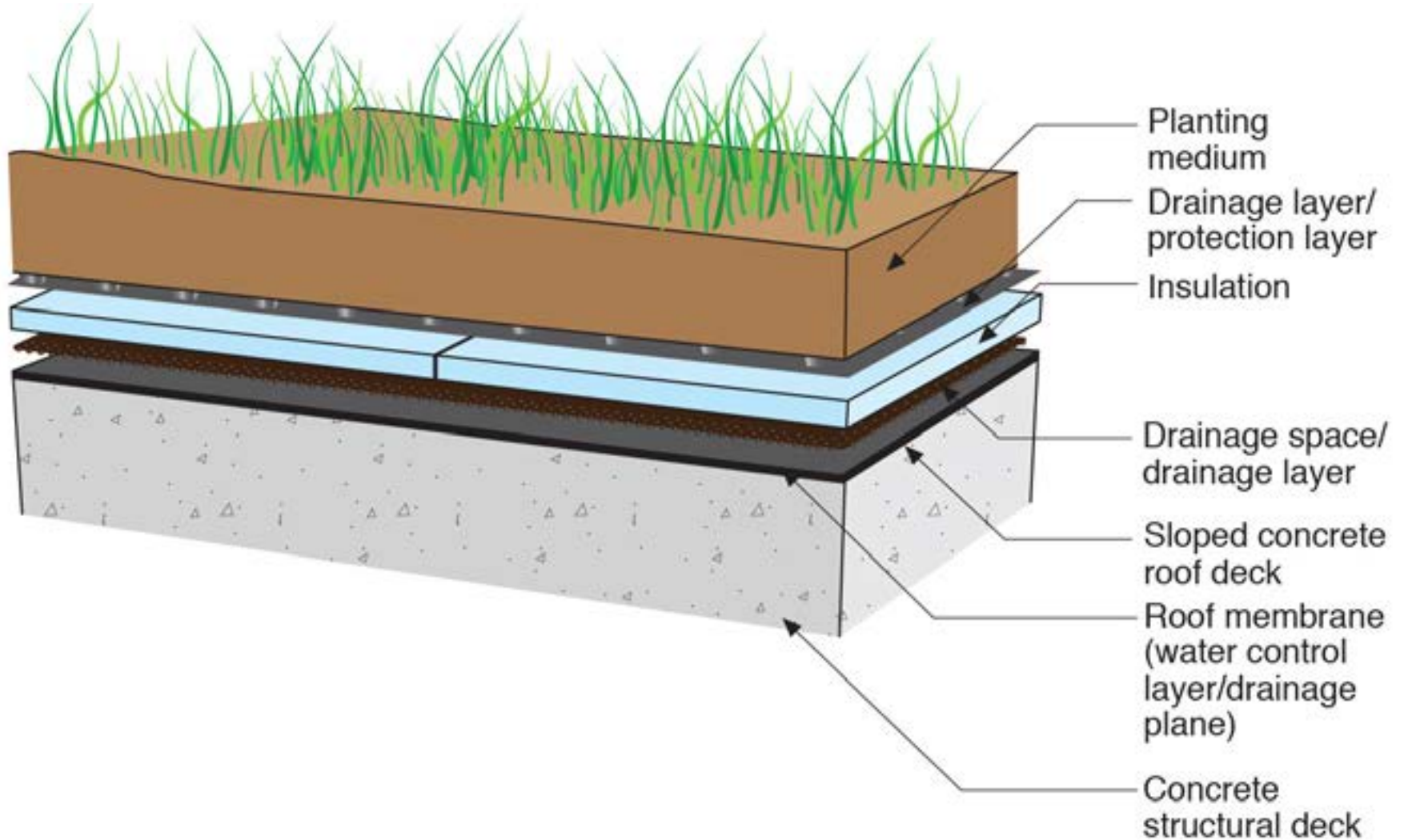

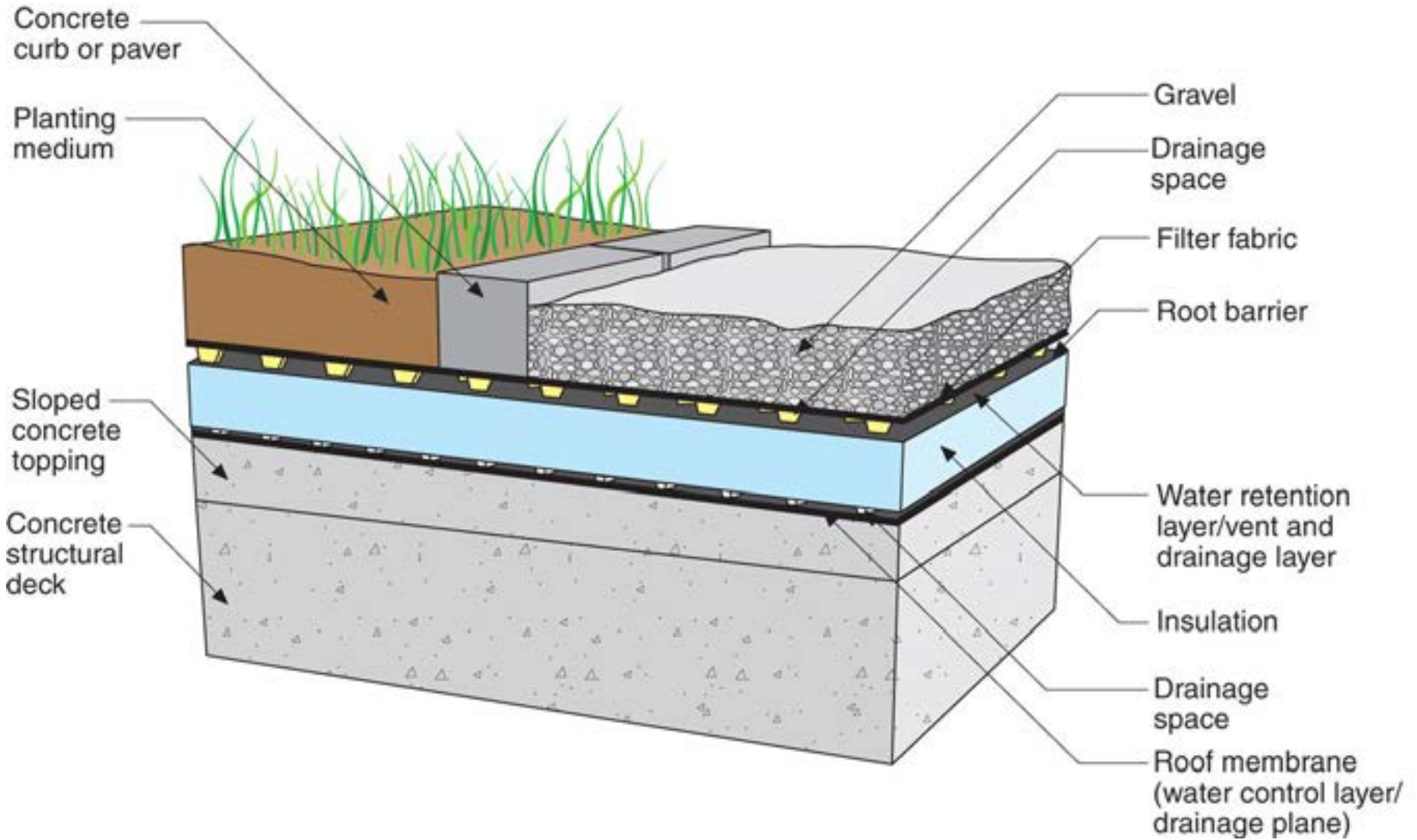













Plaza Decks



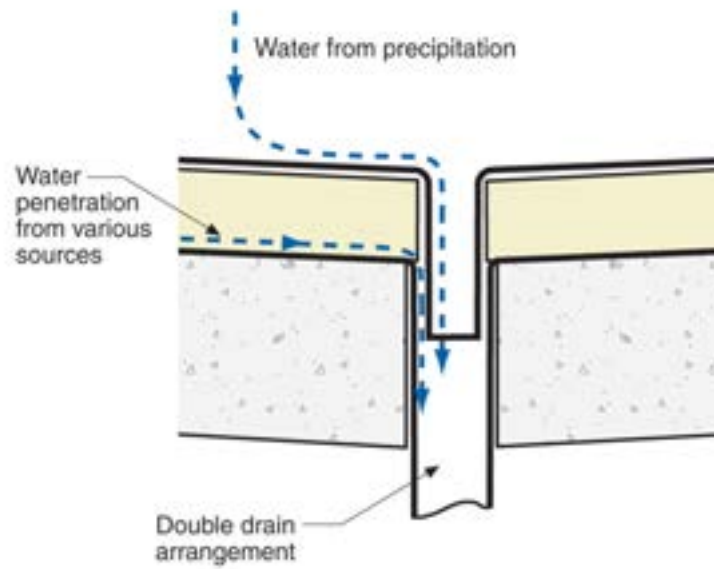
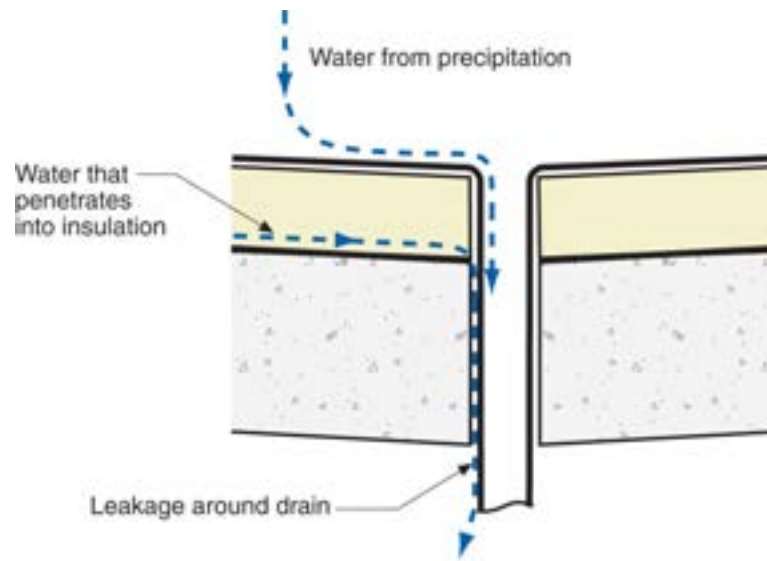

From Baker, M.; *Roofs*, 1980

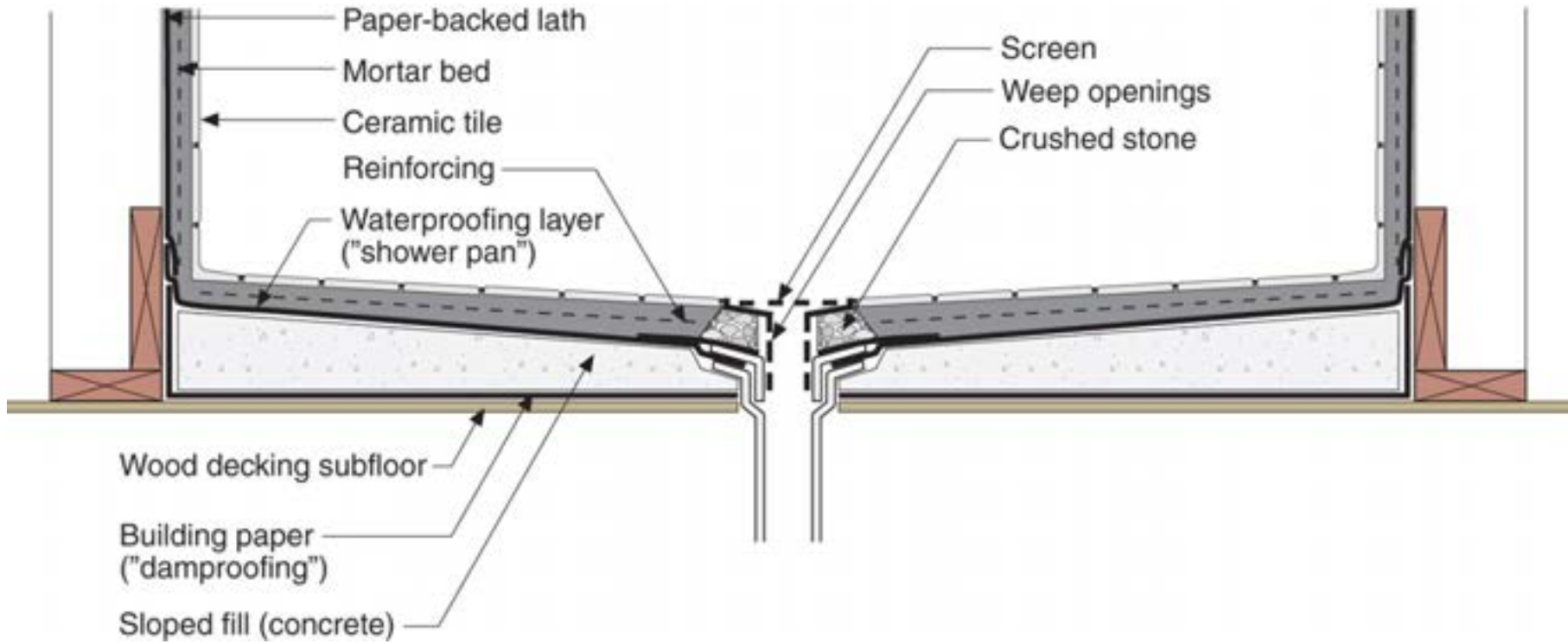

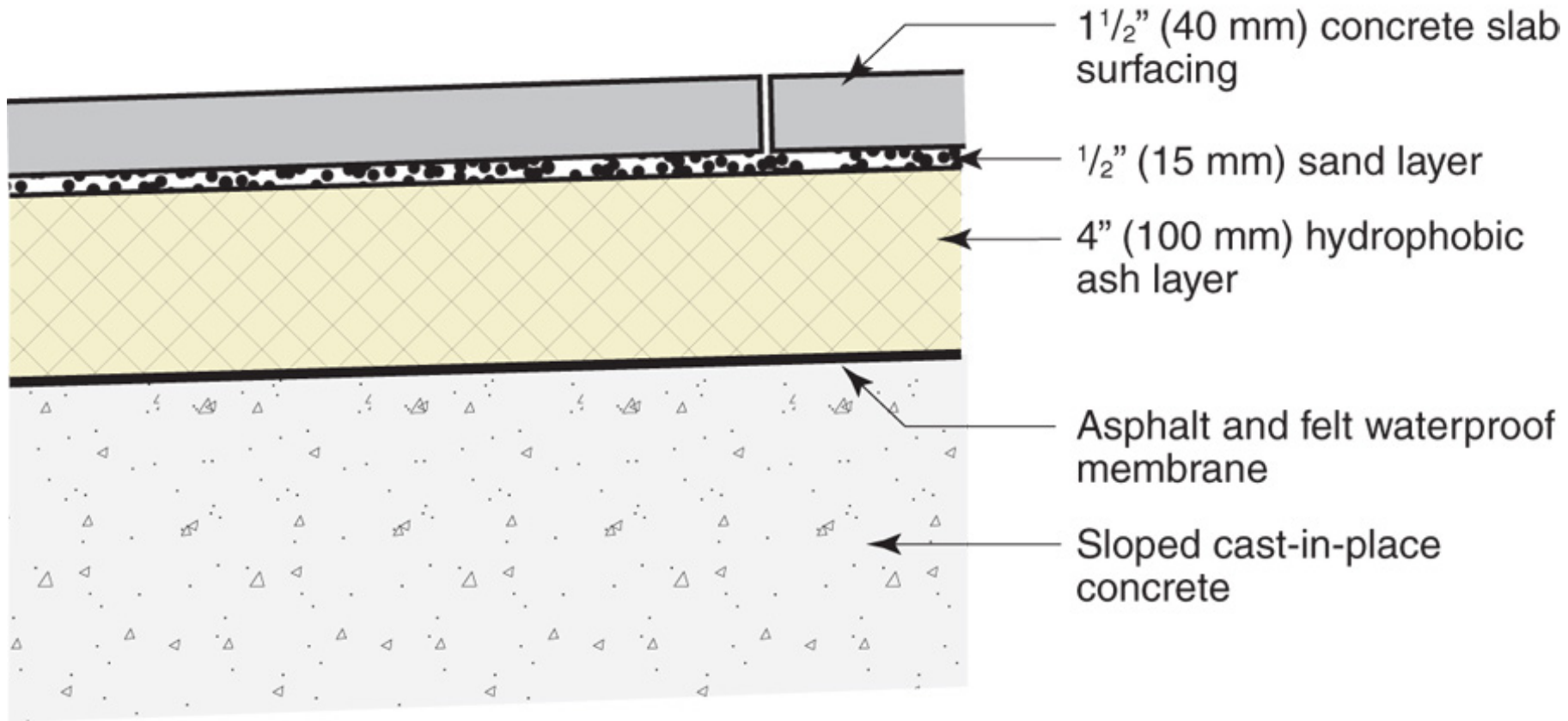

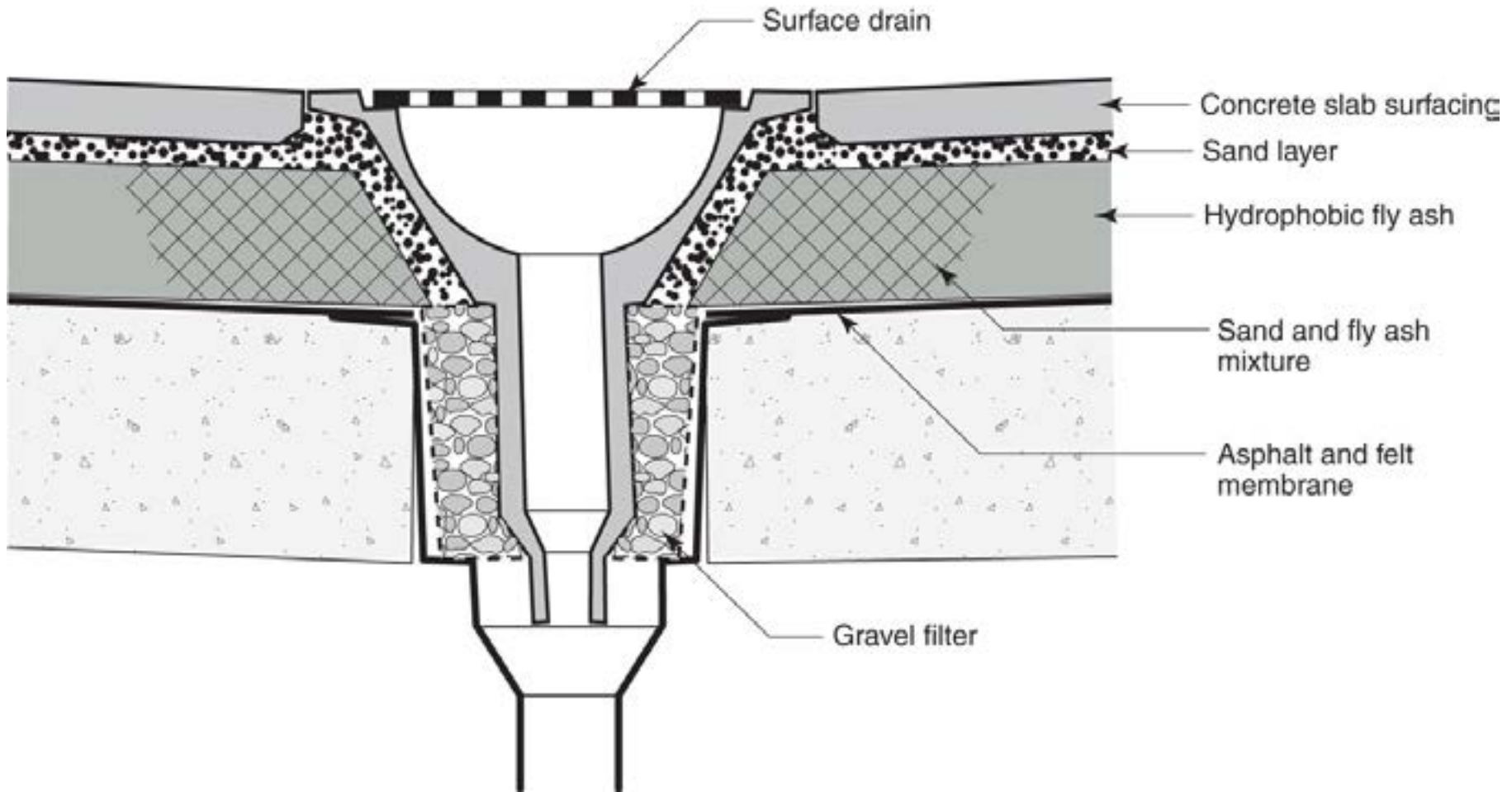

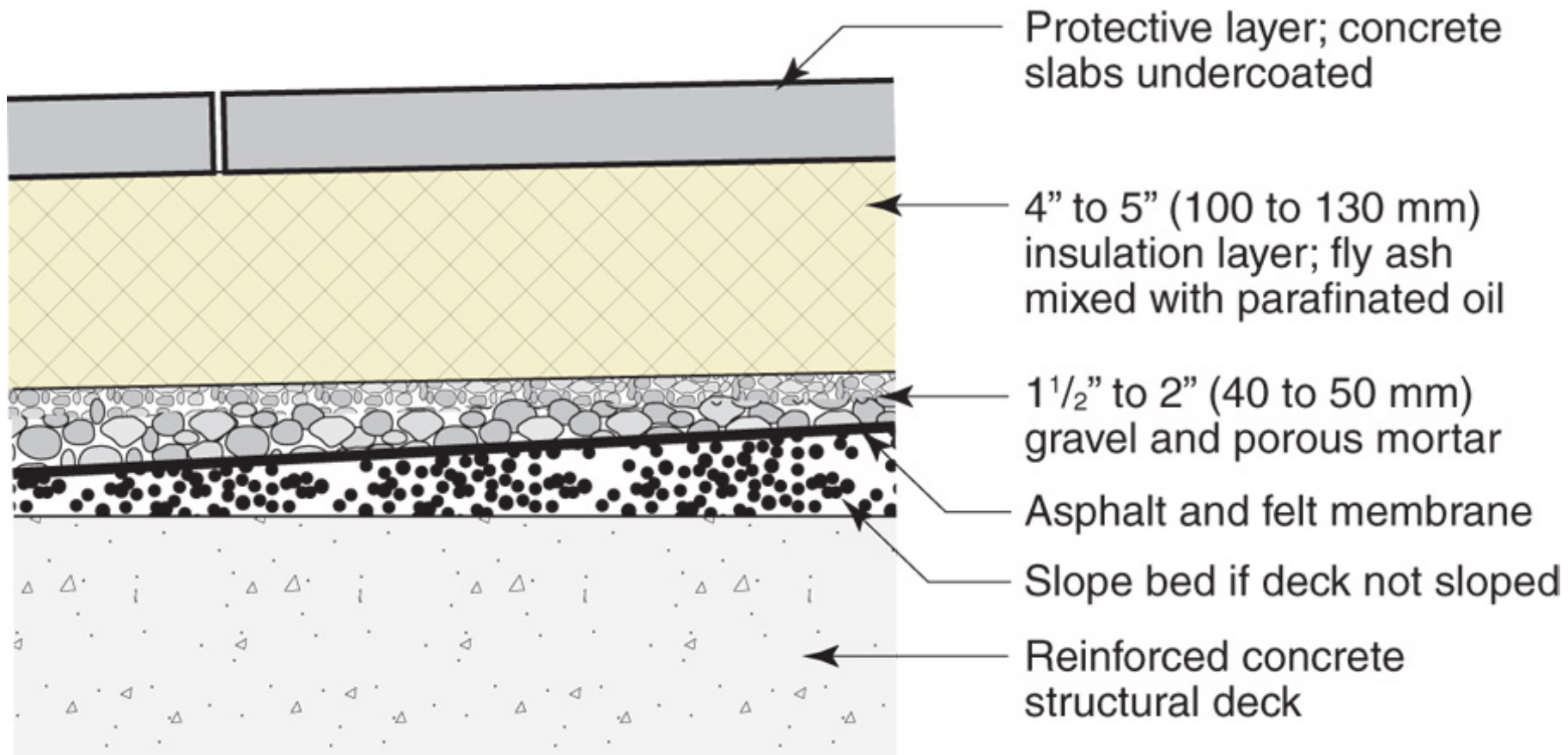

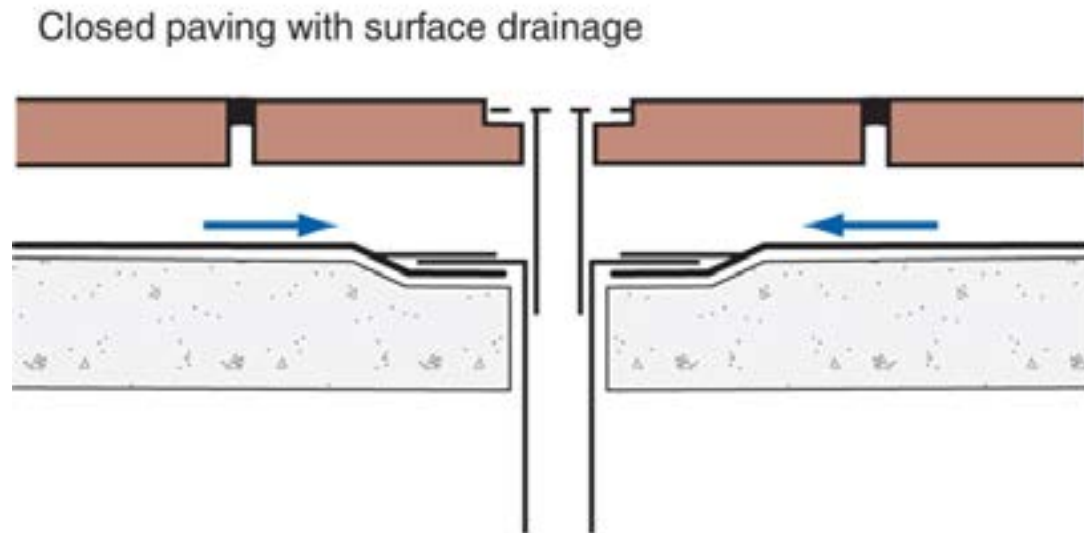
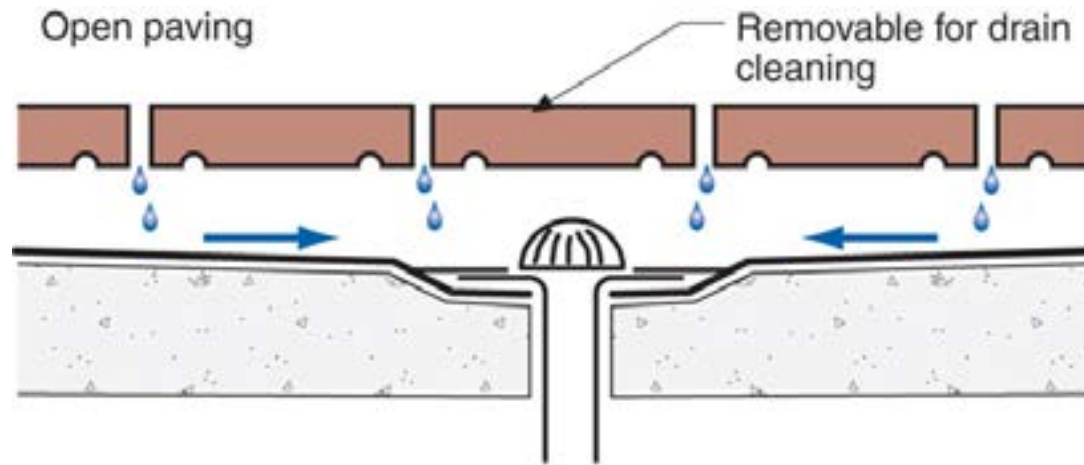

*From Baker, M.; Roofs, 1980
 Courtesy National Research Council of Canada*

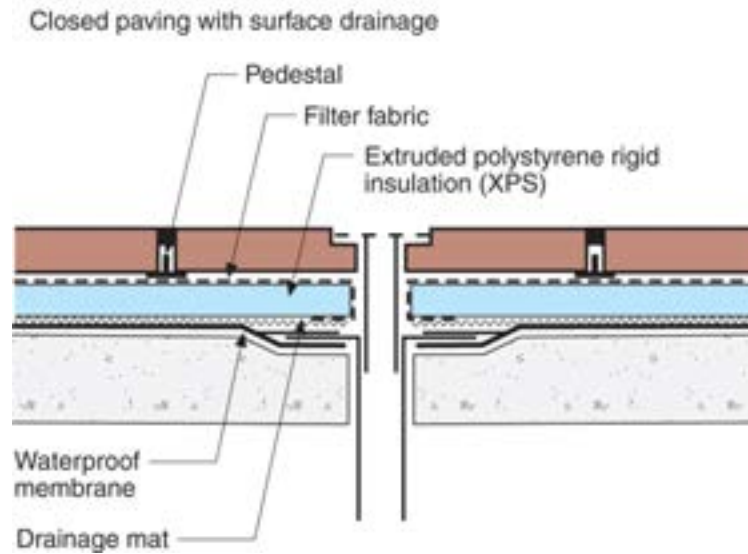
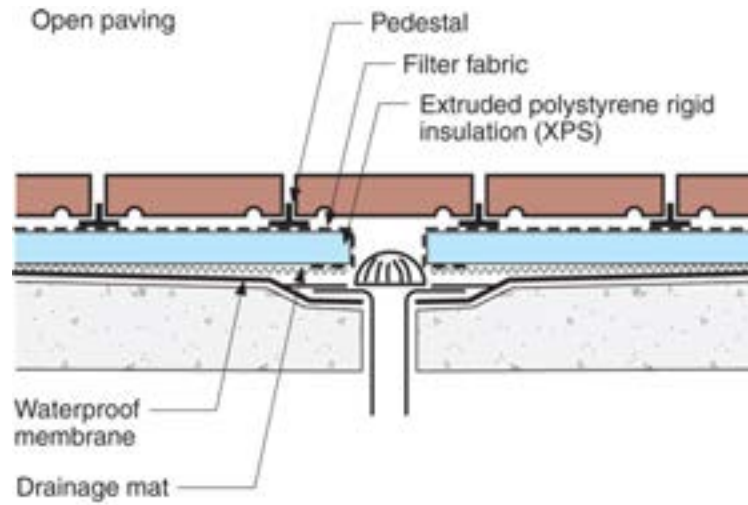





Plaza Decks

Gravity

Drainage Space

Capillary Break

Protection

Isolation

Plaza Decks

Gravity

Drainage Space

Capillary Break

Protection

Isolation

...oh and you better get it right.....

Plaza Decks Are Really Protected Membrane Roofs

Plaza Decks Are Really Protected
Membrane Roofs
Not Easily Serviceable

Plaza Decks Are Really Protected
Membrane Roofs

Not Easily Serviceable

Should Be Isolated And Protected From All
Other Building and Waterproofing
Components

Plaza Deck Systems

Hot Fluid Applied Membranes

Cold Fluid Applied Membranes







Osmosis

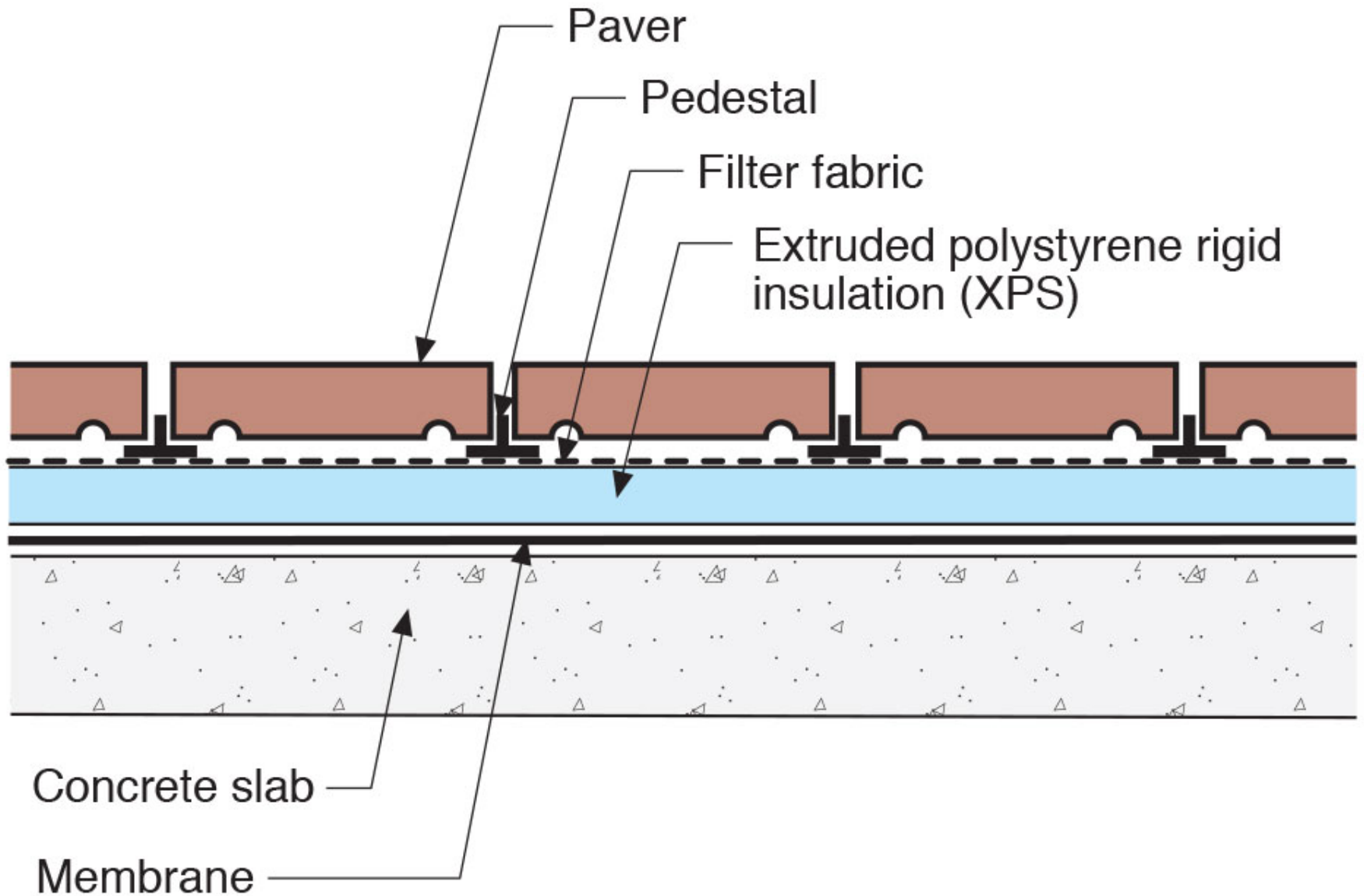

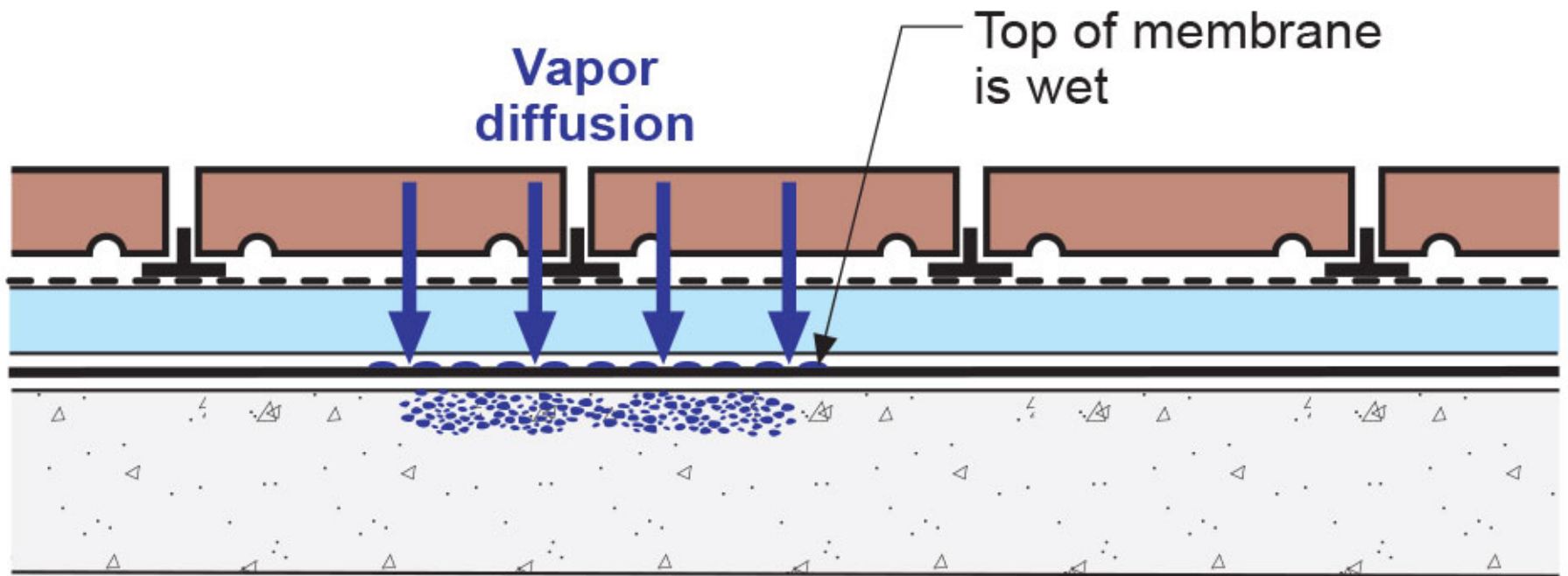

Vapor diffusion

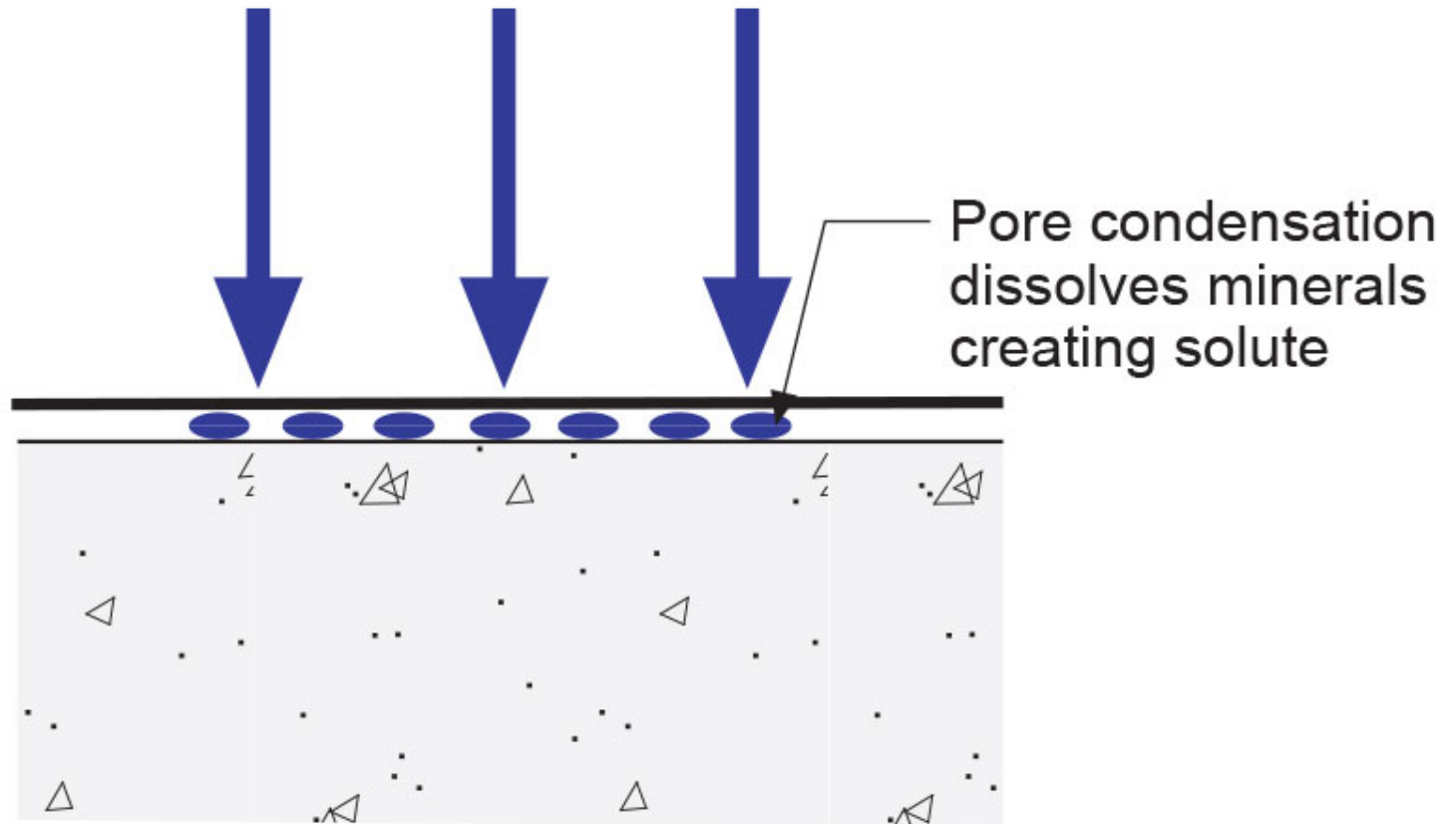

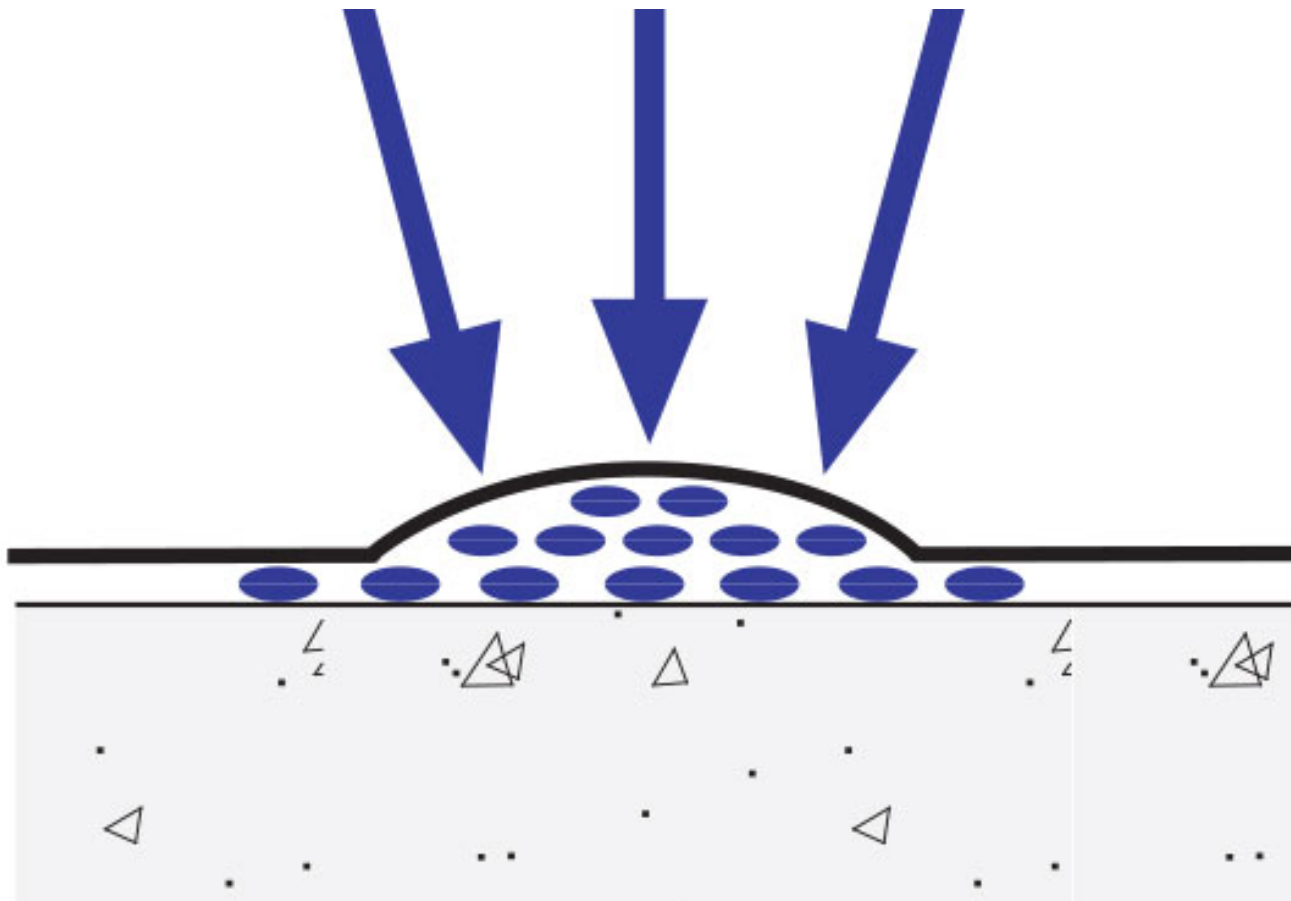



Paver Water Beds!



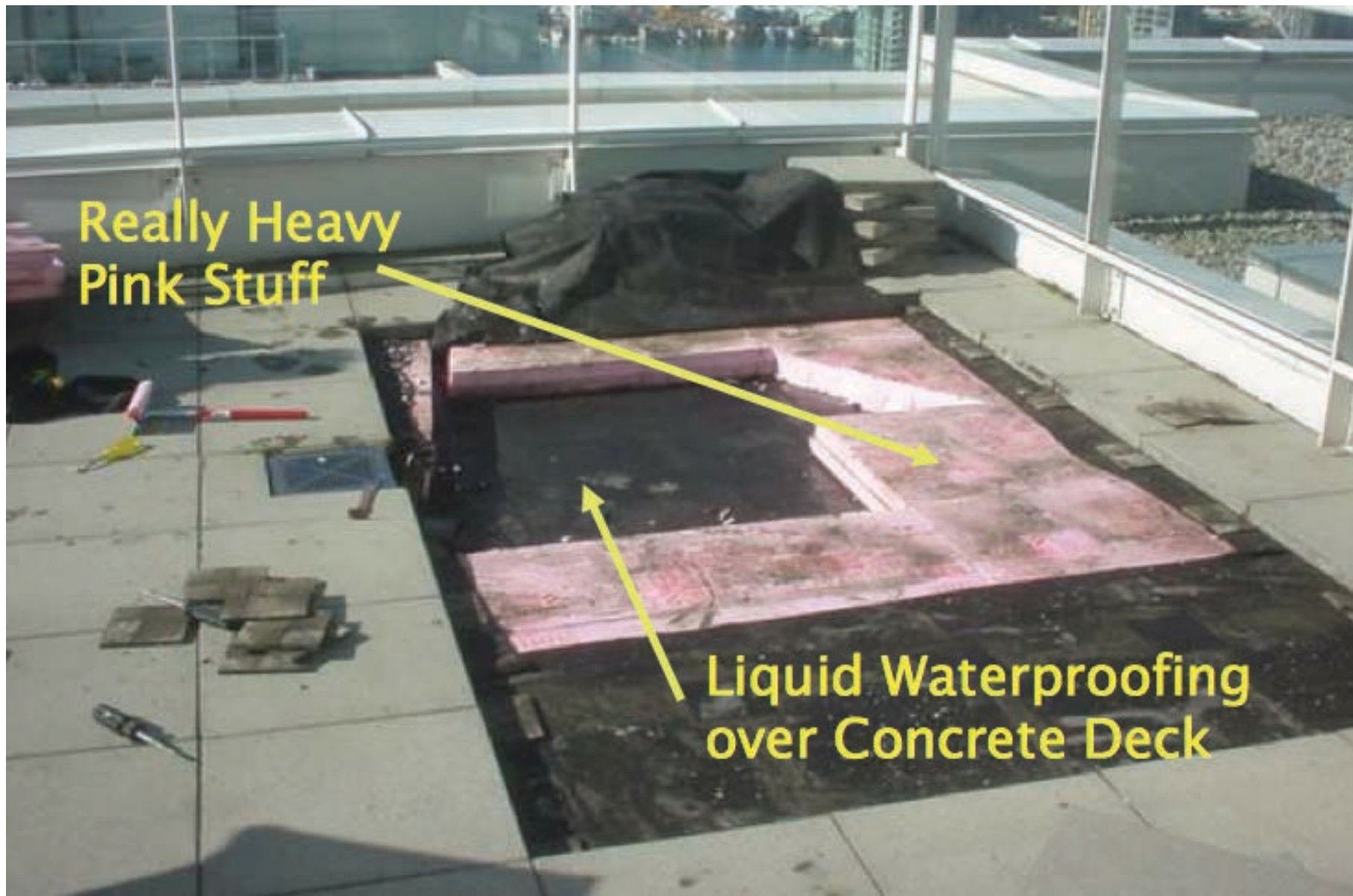

Really Heavy
Pink Stuff

Liquid Waterproofing
over Concrete Deck

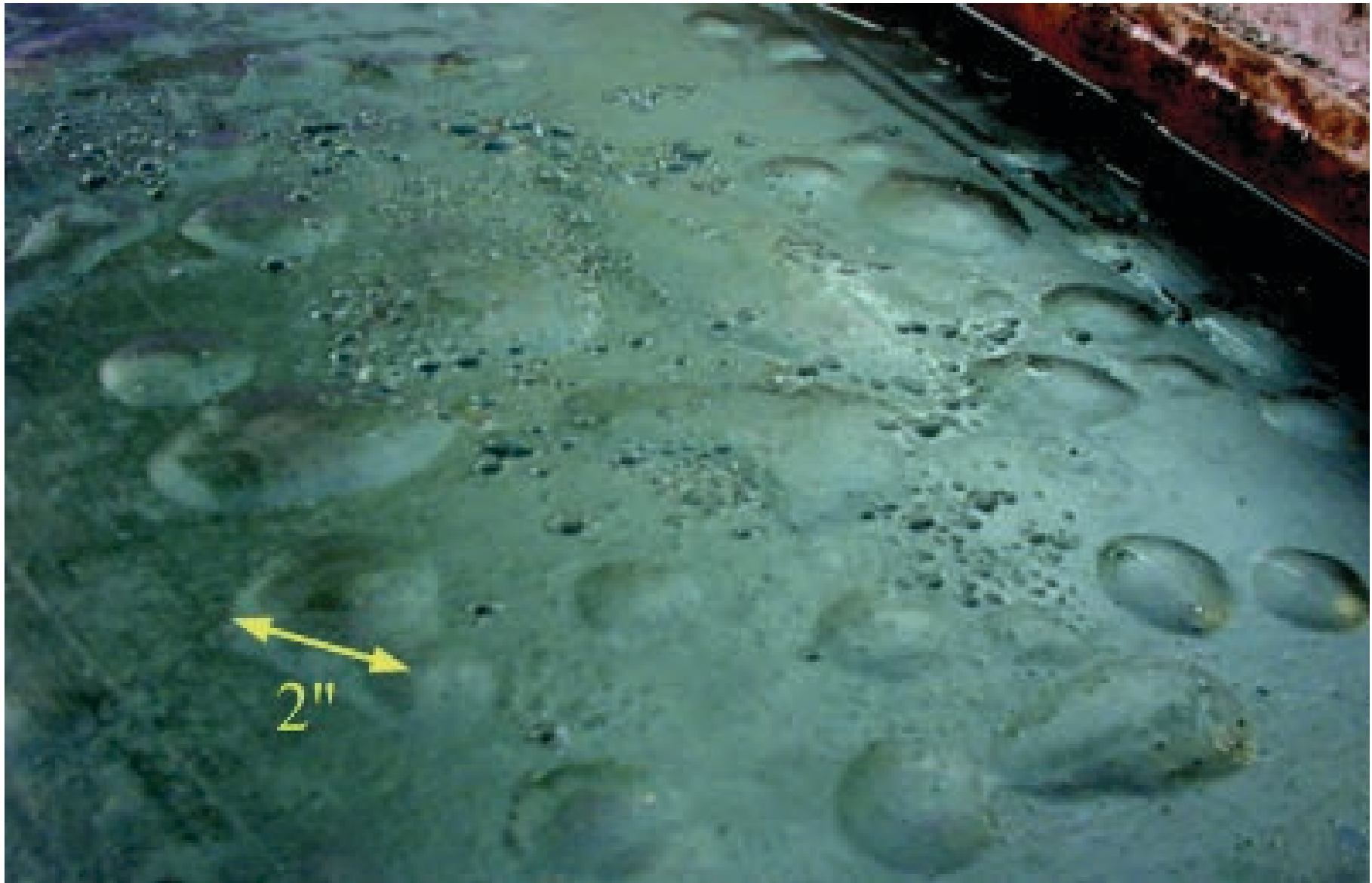



VAPOR PERMEANCE OF LIQUID MEMBRANES

